

One Talk T42U IP Desk Phone

Specifications

A well-rounded SIP phone
for clear communications



Optima
HD Voice



Dual USB
ports



Acoustic
shield



Unified
firmware



Gigabit
Ethernet

The One Talk T42U IP Desk Phone is a feature-rich business tool for excellent communications and extended functionality. With built-in programmable keys, this six-line IP phone provides enhanced productivity. Built with Yealink® Optima HD Voice technology and wideband codec, the T42U provides superb audio quality and crystal-clear voice communications. The T42U comes with dual USB ports, which can be used to add Bluetooth®, Wi-Fi or a USB headset. You can use any two of these options simultaneously according to your needs.

Key features and benefits

Easy customization and high expandability

The T42U is a basic and affordable phone, designed to be your mainstay in the office. The T42U comes with two USB ports that can be used with Bluetooth and a Wi-Fi adaptor or, if you prefer, a USB headset. The phone also has three pages of flexible buttons that can be easily programmed with 15 direct station selection (DSS) keys.

HD audio

Yealink Optima HD Voice technology combines cutting-edge hardware and software with wideband technology for optimum acoustic performance. And its hearing-aid compatible (HAC) handset helps those who need it to hear more clearly.

Efficient installation and provisioning

The T42U supports zero-touch provisioning without any complex manual settings, which makes the T42U simple to deploy and easy to maintain and upgrade.



What you get with the One Talk T42U IP Desk Phone

- 2.7" 192 x 64-pixel graphical LCD with backlight
- Dual USB ports
- Power over Ethernet (PoE) support
- Gigabit Ethernet
- USB headset and EHS support
- Wi-Fi via WF40/WF50
- Bluetooth via BT40/BT41
- Stand with two adjustable angles
- Wall mountable

Secure transport and interoperability

The T42U series uses Session Initiation Protocol (SIP) over Transport Layer Security/Secure Sockets Layer (TLS/SSL), which is the latest network security technology. It's also compatible with leading soft switch suppliers, such as 3CX and BroadSoft BroadWorks.

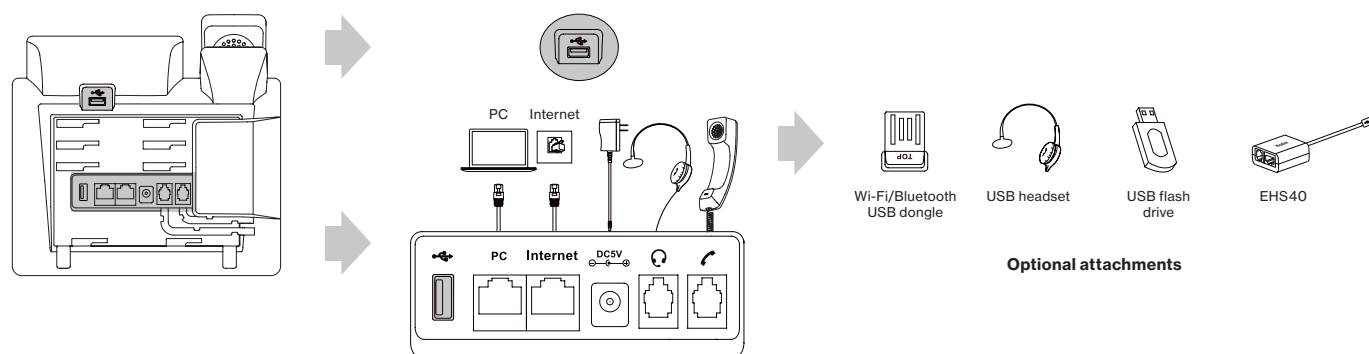

Specifications

Audio features

- HD Voice: HD handset, HD speaker
- Hearing-aid compatible (HAC) handset
- Acoustic shield
- Wideband codec: AMR-WB
- Narrowband codec: AMR-N
- DTMF: In-band, out-of-band (RFC 2833) and SIP INFO
- Full-duplex hands-free speakerphone

Phone features

- One-touch speed dial, redial
- Call forwarding, call waiting, call transfer, call hold
- Mute and do not disturb (DND)
- Six-way conference calling
- Ringtone selection
- Set date and time manually or automatically
- RTCP-XR (RFC3611), VQ-RTCPXR (RFC6035)
- Dual USB ports (2.0 compliant)
- Bluetooth earphone through BT40/BT41
- Wi-Fi through WF40/WF50
- USB call recording through USB flash drive
- USB headset
- EHS40 wireless headset adaptor
- Enhanced DSS key
- Busy lamp field (BLF), bridged line appearance (BLA)
- Anonymous call, anonymous call rejection
- Voice mail
- Call park, call pickup

Directory

- Local phone book—up to 1,000 entries
- Blocklist
- Remote phone book
- Smart dialing
- Call history: dialed/received/missed/forwarded

Display and indicator

- 2.7" 192 x 64-pixel graphical LCD with backlight
- LED for call and message waiting indication
- Dual-color (red or green) illuminated LEDs for line status information
- Intuitive user interface with icons and soft keys
- Multilingual user interface
- Caller ID with name and number
- Power saving

Feature keys

- Six line keys with LED
- Six line keys can be programmed; up to 15 paperless DSS keys (three-page view)
- Five feature keys: message, headset, mute, redial, hands-free speakerphone
- Four context-sensitive “soft” keys
- Six navigation keys
- Two volume control keys
- Illuminated mute key
- Illuminated headset key
- Illuminated hands-free speakerphone key

Interface

- 2 x RJ45 10/100/1000M Ethernet ports
- PoE (IEEE 802.3af), Class 2
- 2 x USB port (2.0 compliant)
- 1 x RJ9 (4P4C) handset port
- 1 x RJ9 (4P4C) headset port

Other physical features

- Color: classic grey
- Stand with two adjustable angles
- Wall mountable
- External Yealink AC adaptor (optional): AC 100 V to 240 V input and DC 5 V/1.2 A output
- USB output current: 5 V 500 mA
- Power consumption (PSU): 0.9 W to 2.2 W
- Power consumption (PoE): 1.3 W to 2.9 W
- Dimension (W x D x H x T):
212 mm x 189 mm x 175 mm x 54 mm
- Operating humidity: 10% to 95%
- Operating temperature: 0° C to 40° C (+32° F to 104° F)

Management

- Phone lock for personal privacy protection
- Reset to factory, reboot
- Package tracing export, system log

Network and security

- SIP v1 (RFC2543), v2 (RFC3261)
- NAT traversal: STUN mode
- IP assignment: static/DHCP
- HTTP/HTTPS web server
- Time and date synchronization using SNTP
- UDP/TCP/DNS-SRV(RFC 3263)
- QoS: 802.1p/Q tagging (VLAN), Layer 3 ToS DSCP
- SRTP for voice
- Transport Layer Security (TLS)
- HTTPS certificate manager
- AES encryption for configuration file
- Digest authentication
- IPv6
- LLDP/CDP/DHCP VLAN

Package content

- T42U IP Desk Phone
- Handset with handset cord
- Ethernet cable (2 m CAT-5E UTP cable)
- Stand
- Quick start guide
- Power adaptor (optional)
- Wall mount bracket (optional)

Compliance

REACH

ISO 9001



**For more support information, please visit
[verizon.com/support/one-talk](https://www.verizon.com/support/one-talk)**