



US 20080234799A1

(19) **United States**

(12) **Patent Application Publication**

Acosta et al.

(10) **Pub. No.: US 2008/0234799 A1**

(43) **Pub. Date: Sep. 25, 2008**

(54) **CUSTOM-LENGTH STENT DELIVERY SYSTEM WITH INDEPENDENTLY OPERABLE EXPANSION ELEMENTS**

Related U.S. Application Data

(63) Continuation of application No. 11/104,305, filed on Apr. 11, 2005, now Pat. No. 7,402,168.

(75) Inventors: **Pablo Acosta**, Newark, CA (US);
David Sanderson, Burlingame, CA (US)

Publication Classification

(51) **Int. Cl.**
A61F 2/84 (2006.01)
(52) **U.S. Cl.** **623/1.12; 623/1.11**
(57) **ABSTRACT**

Correspondence Address:
TOWNSEND AND TOWNSEND AND CREW, LLP
(CLIENT NO 021629-000000)
TWO EMBARCADERO CENTER, 8TH FLOOR
SAN FRANCISCO, CA 94111-3834 (US)

A stent delivery system for delivering a plurality of stent segments to at least one treatment site includes a catheter shaft having a proximal end and a distal end, a plurality of expandable members arranged axially along the catheter shaft near the distal end, a plurality of stent segments, and a selecting mechanism adapted for selecting one or more expandable members for expansion. Each expandable member is expandable independently of at least one other expandable member, and each expandable member has at least one stent segment positioned on it. One or more of the expandable members may be selectively expanded to deploy the one or more stent segments positioned thereon at the treatment site.

(73) Assignee: **XTENT, INC.**, Menlo Park, CA (US)

(21) Appl. No.: **12/133,909**

(22) Filed: **Jun. 5, 2008**

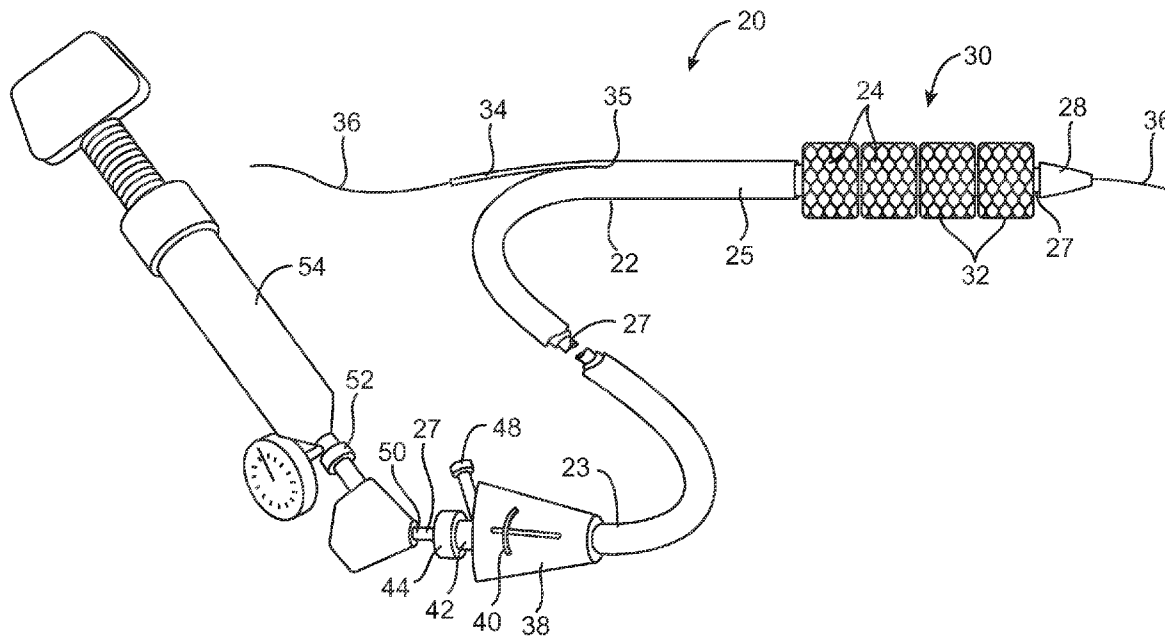

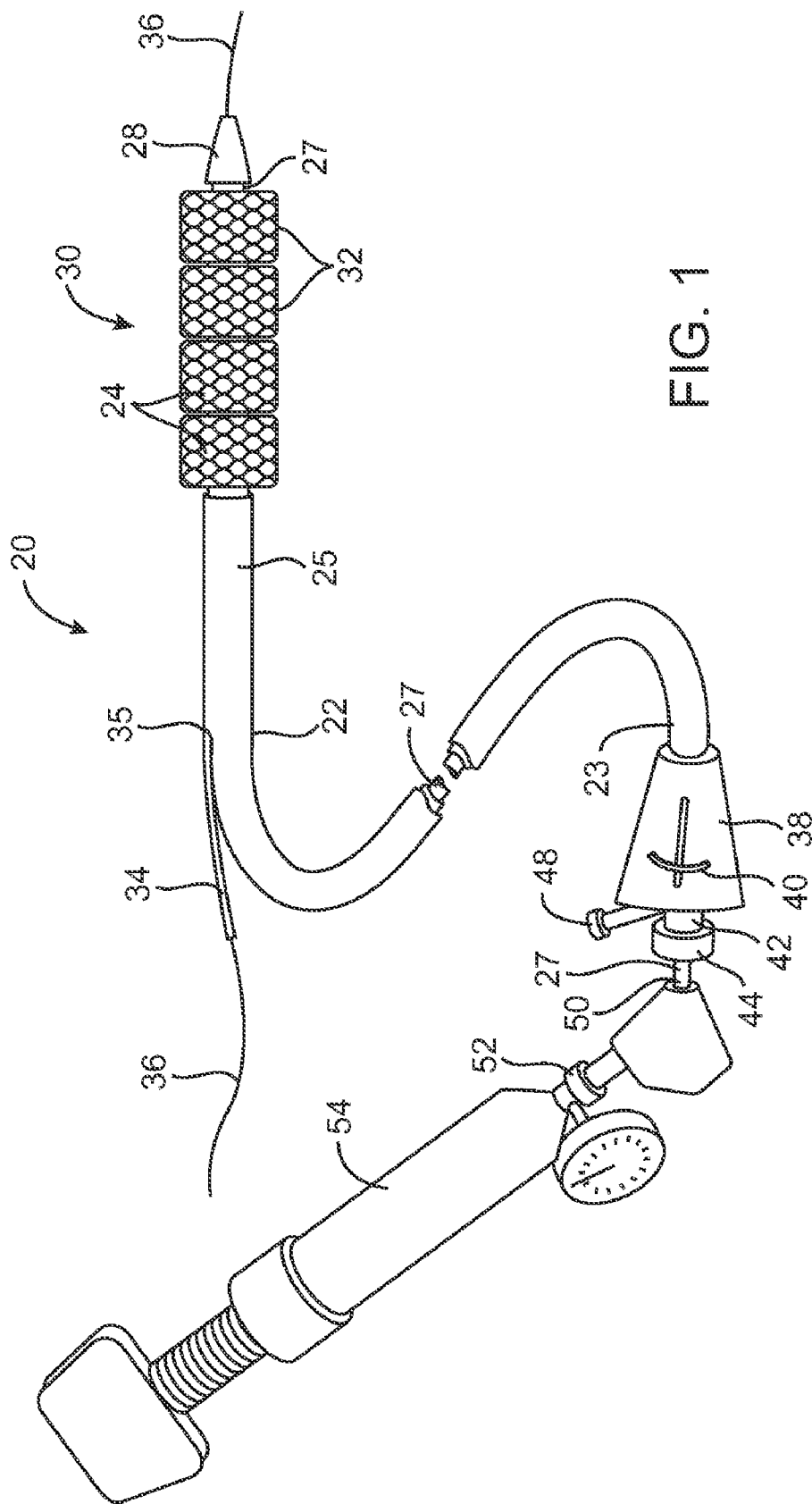

FIG. 1

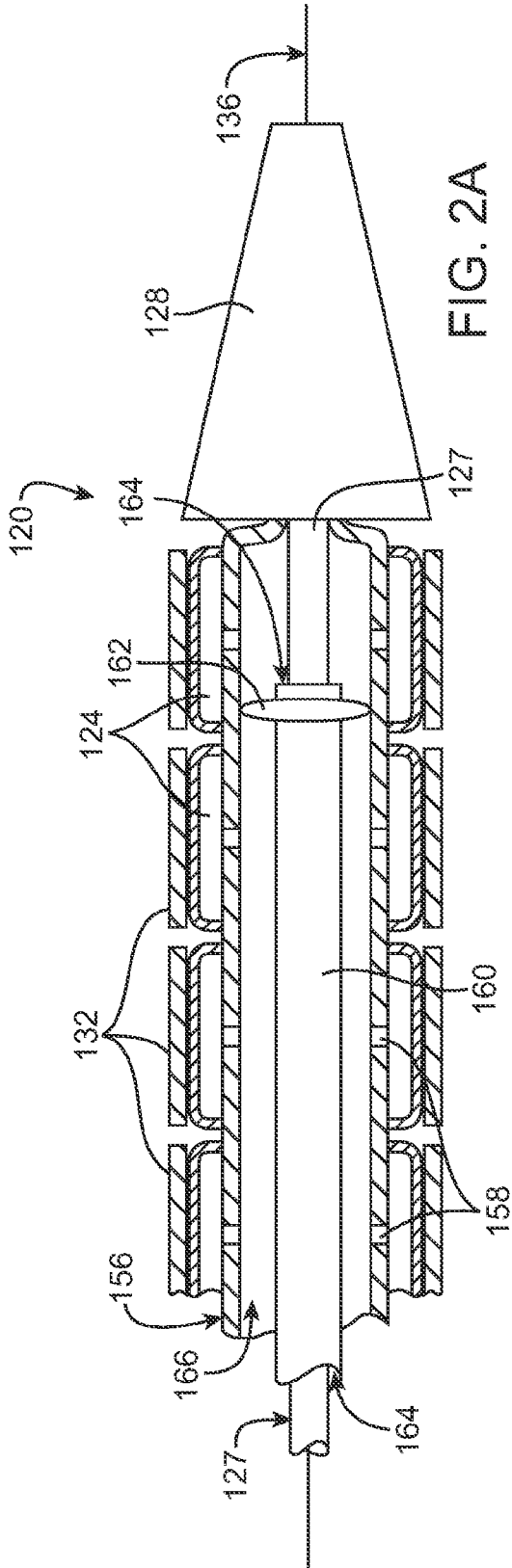

FIG. 2A

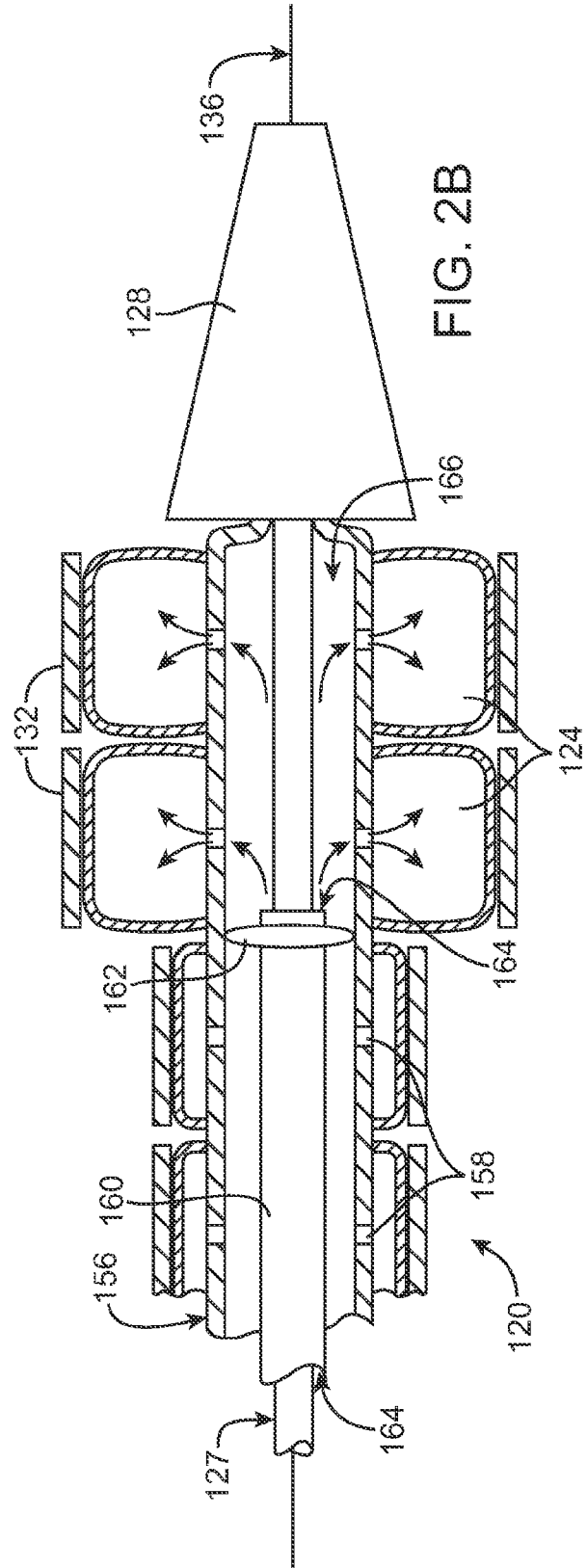

FIG. 2B

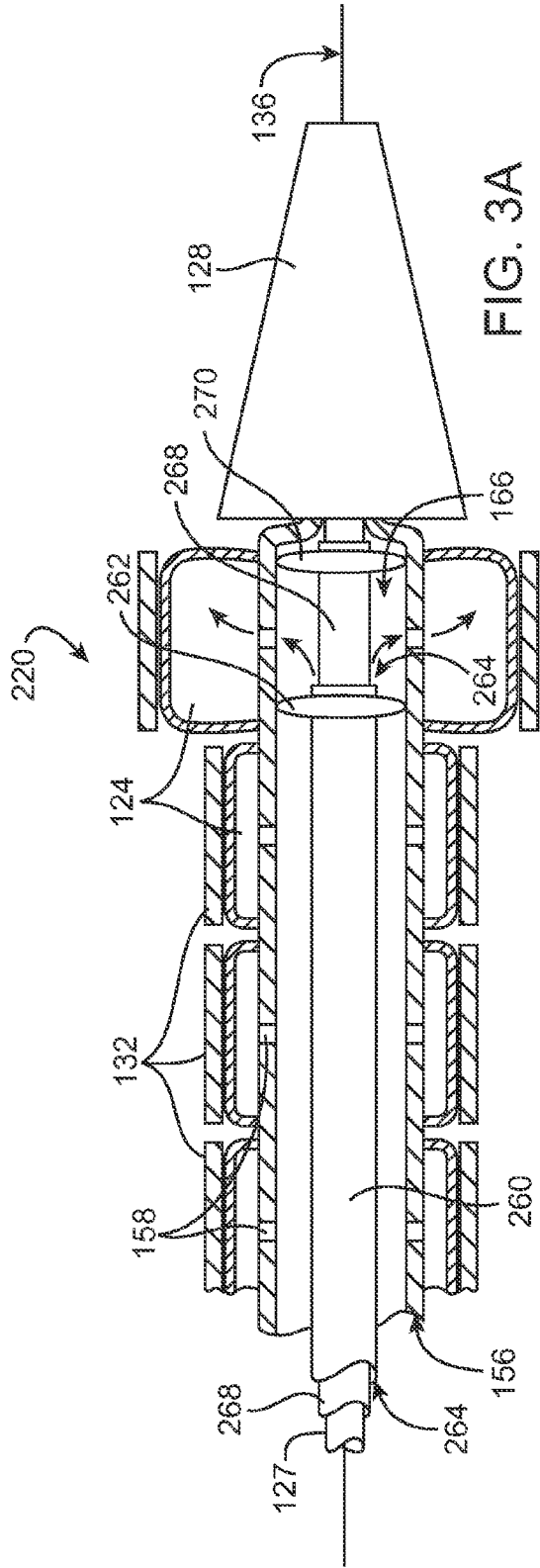

FIG. 3A

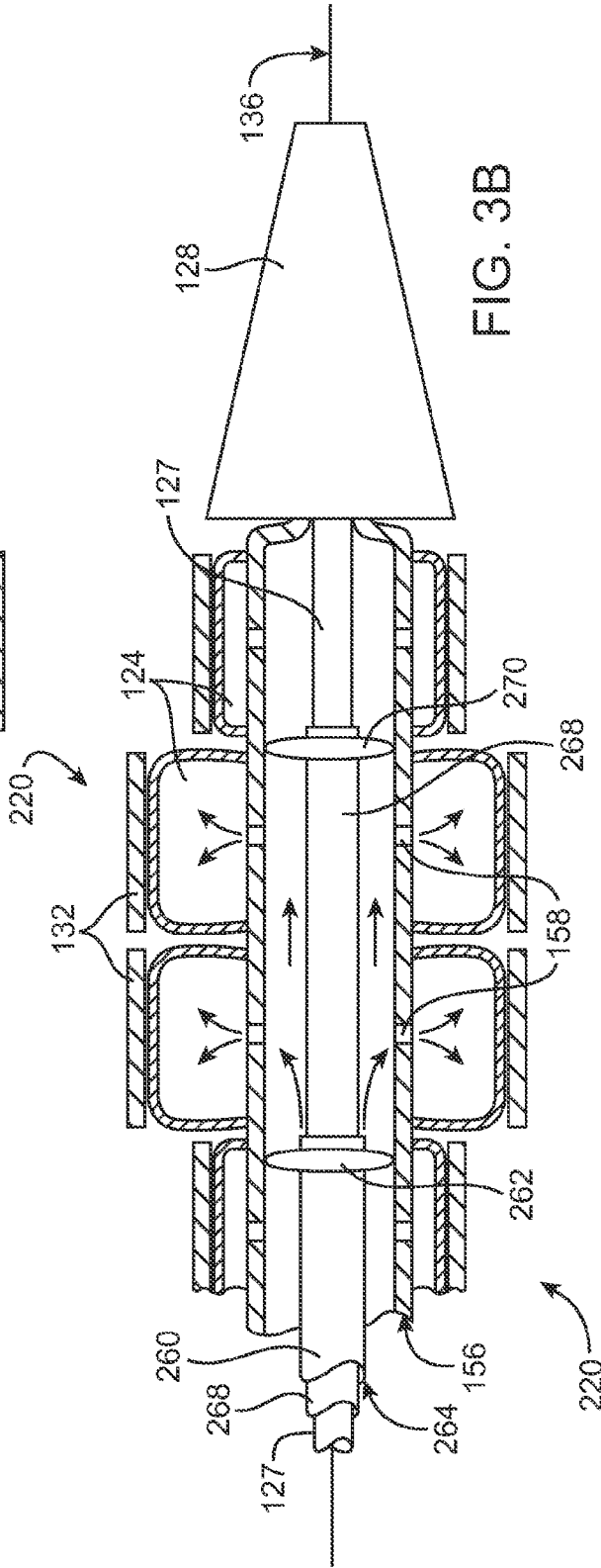

FIG. 3B

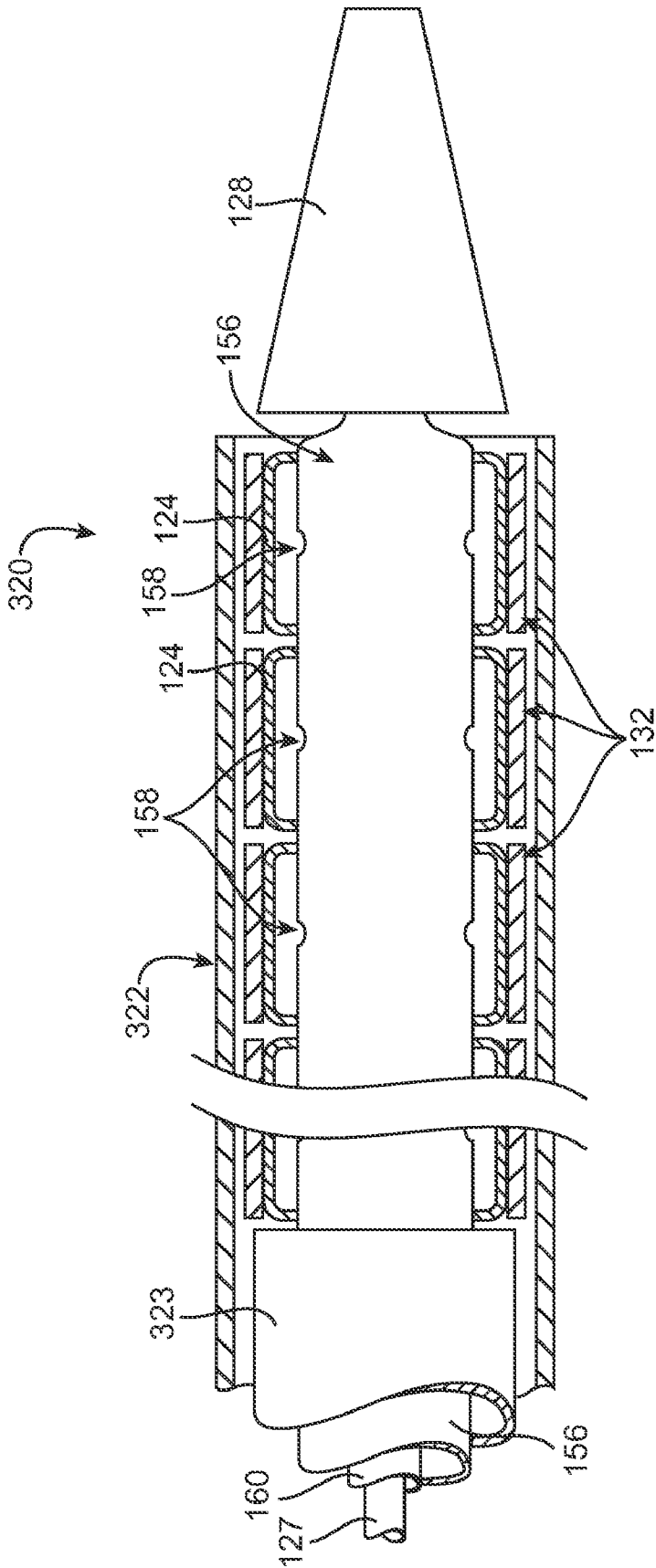
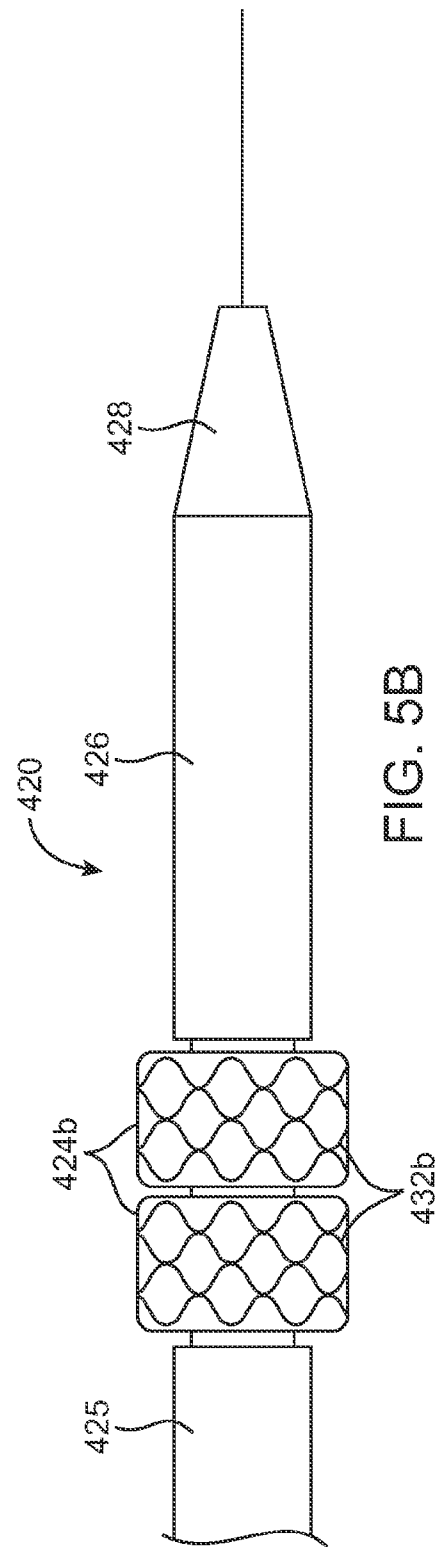
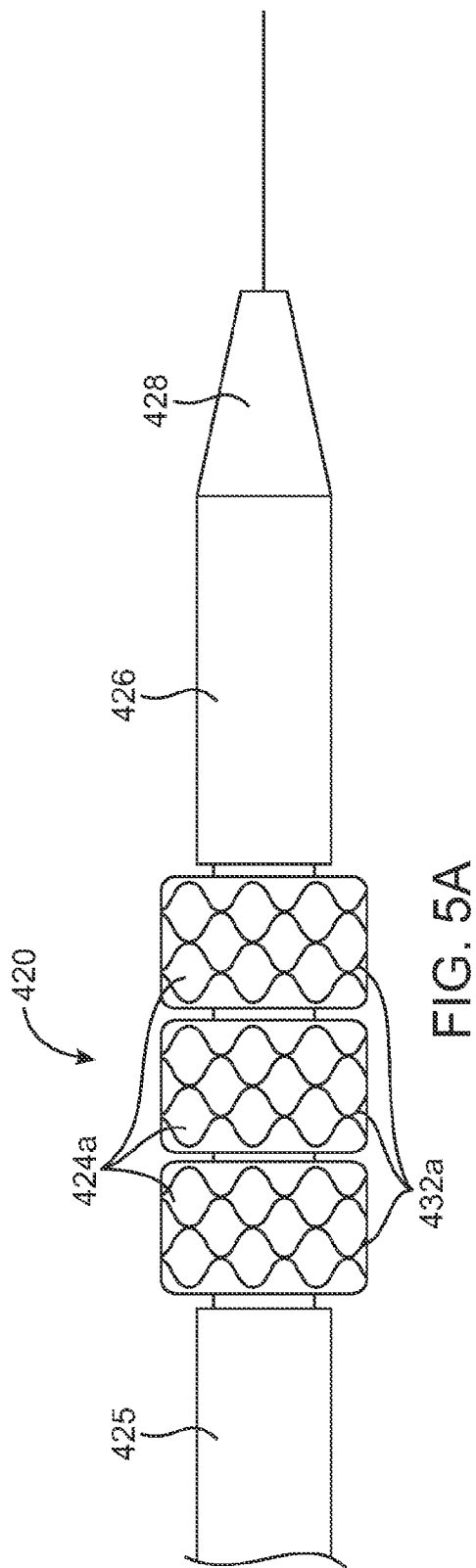

FIG. 4



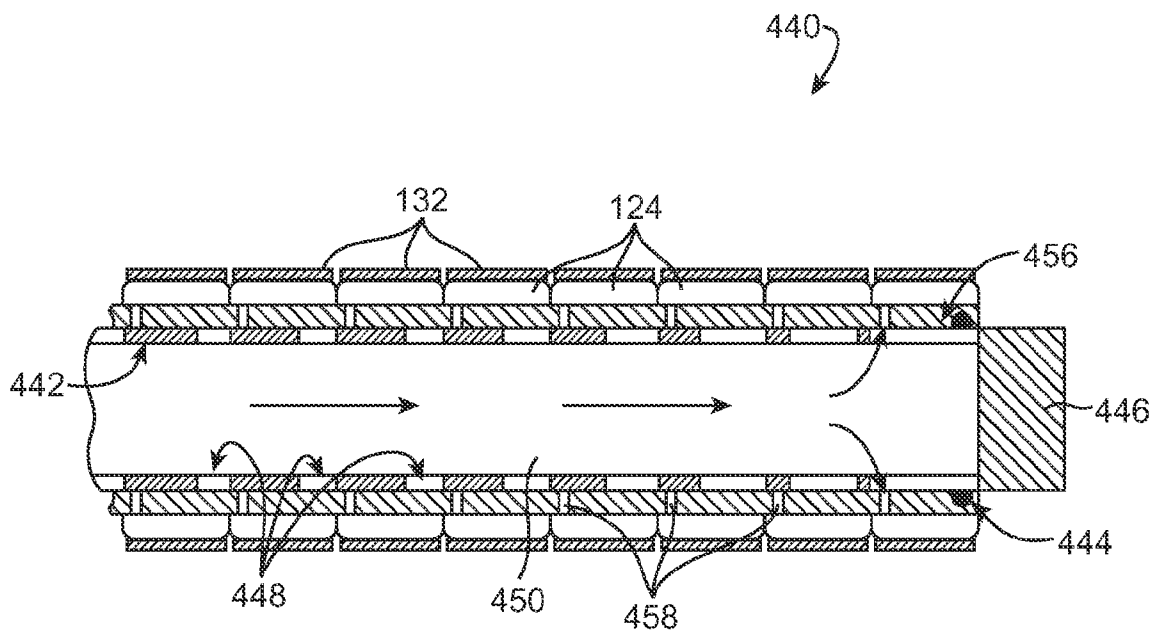
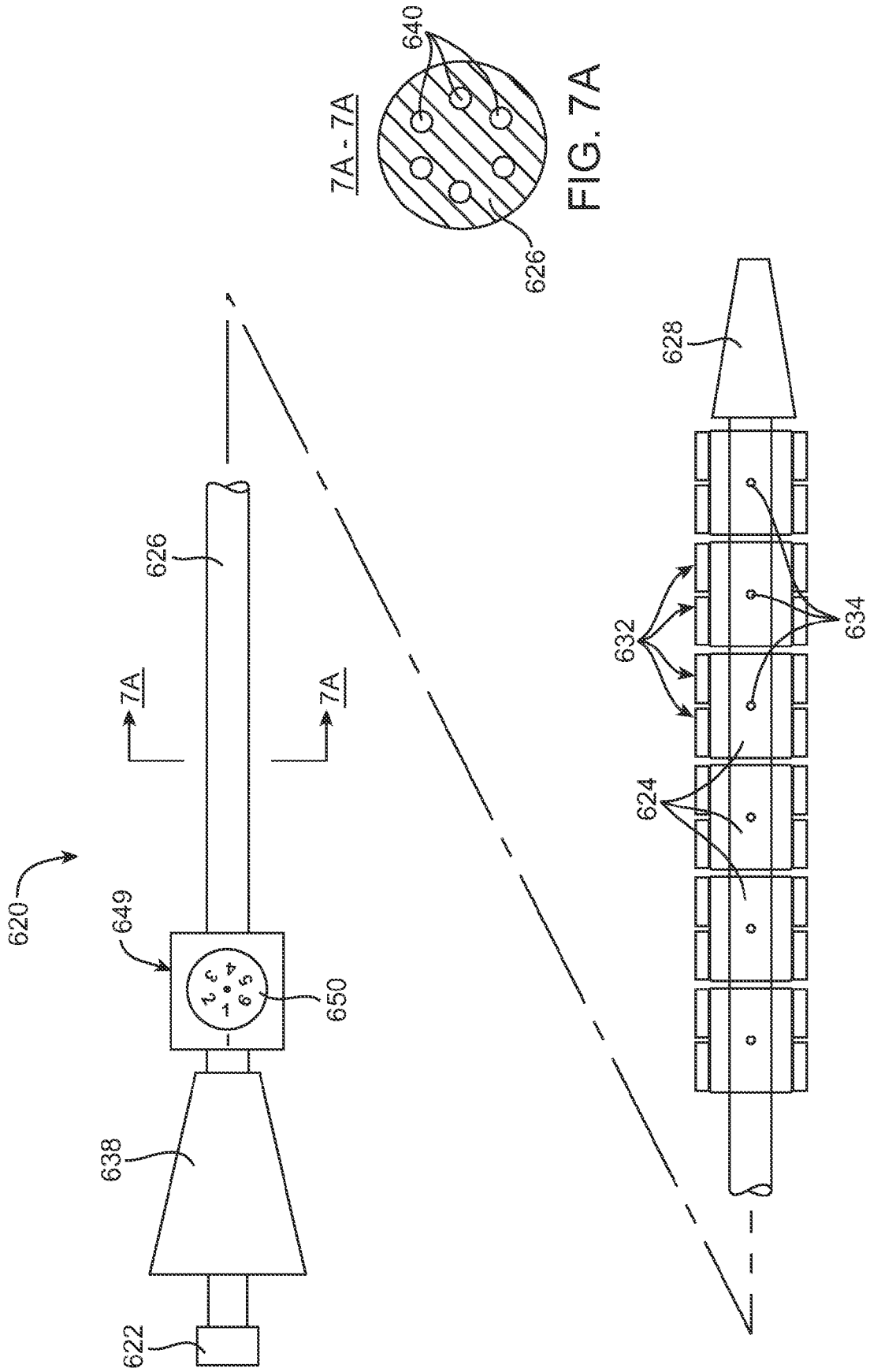

FIG. 6



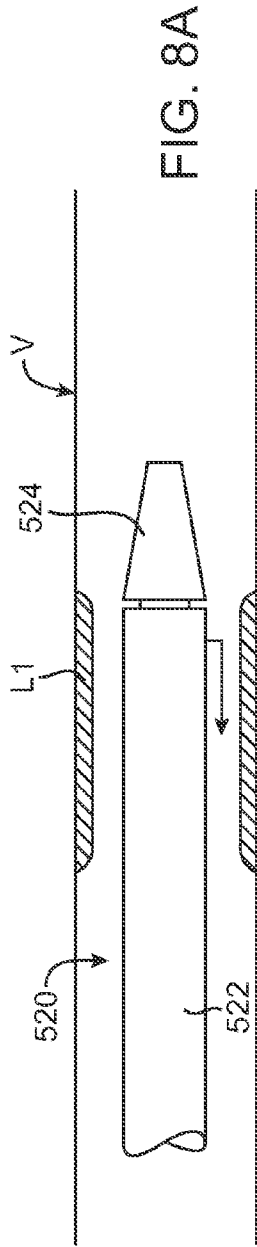

FIG. 8A

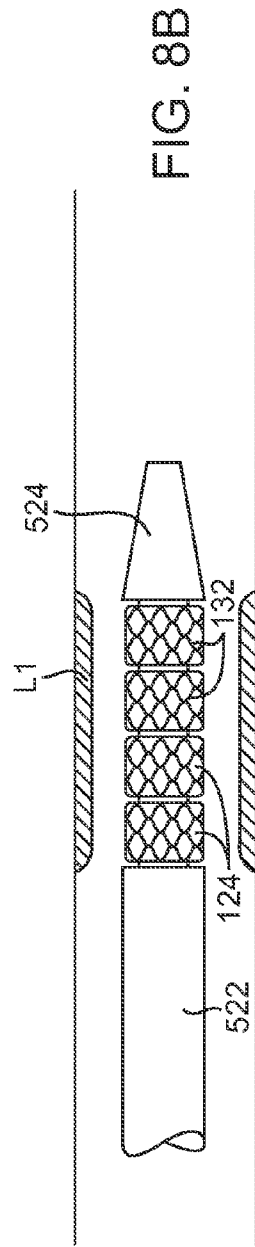

FIG. 8B

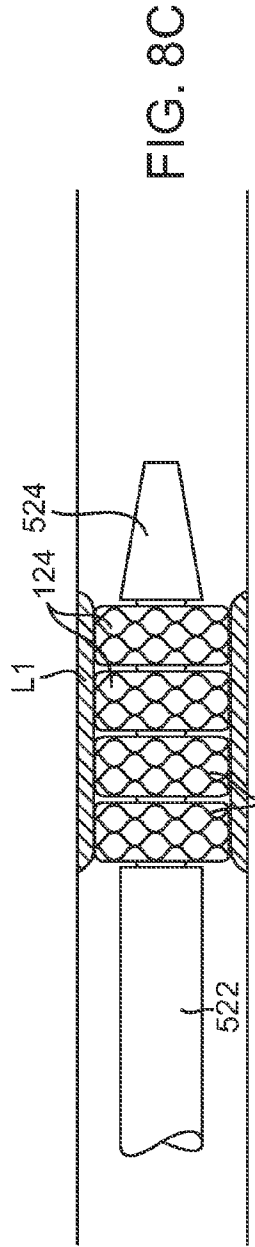

FIG. 8C

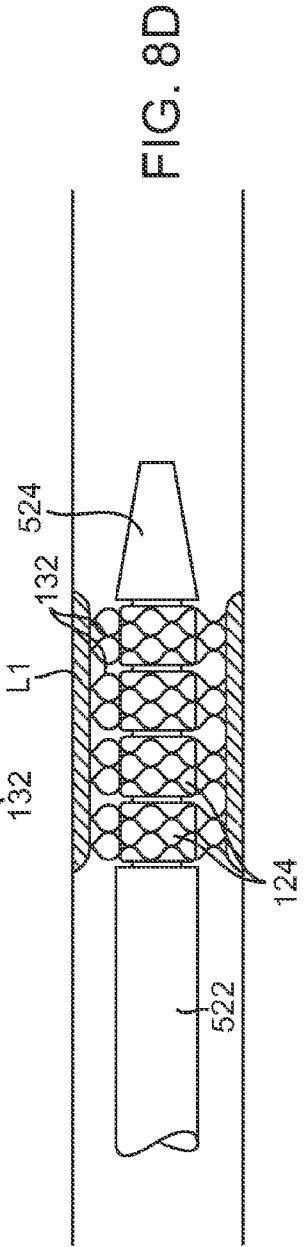
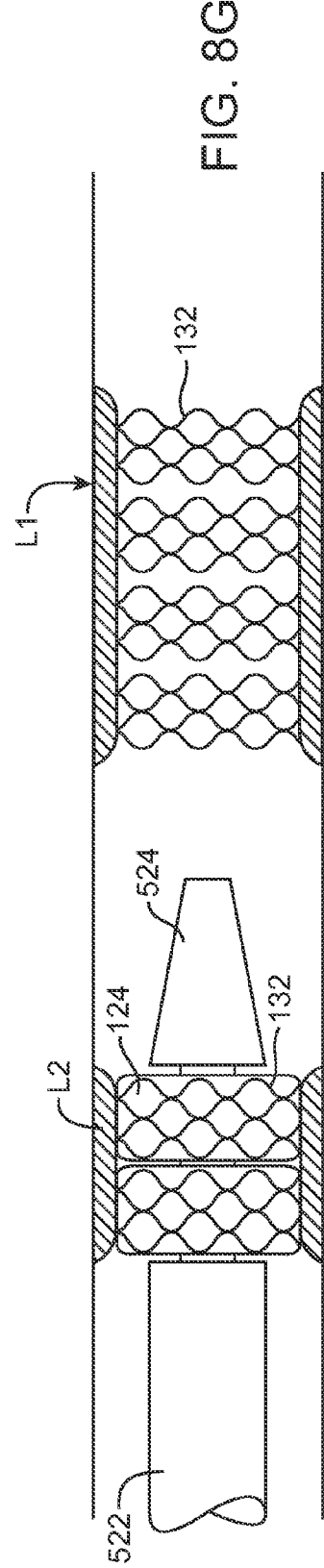
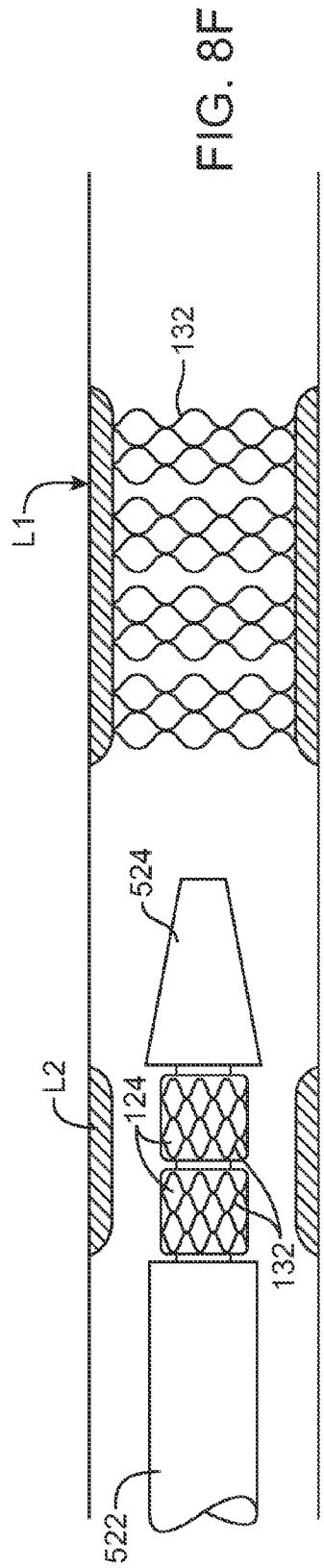
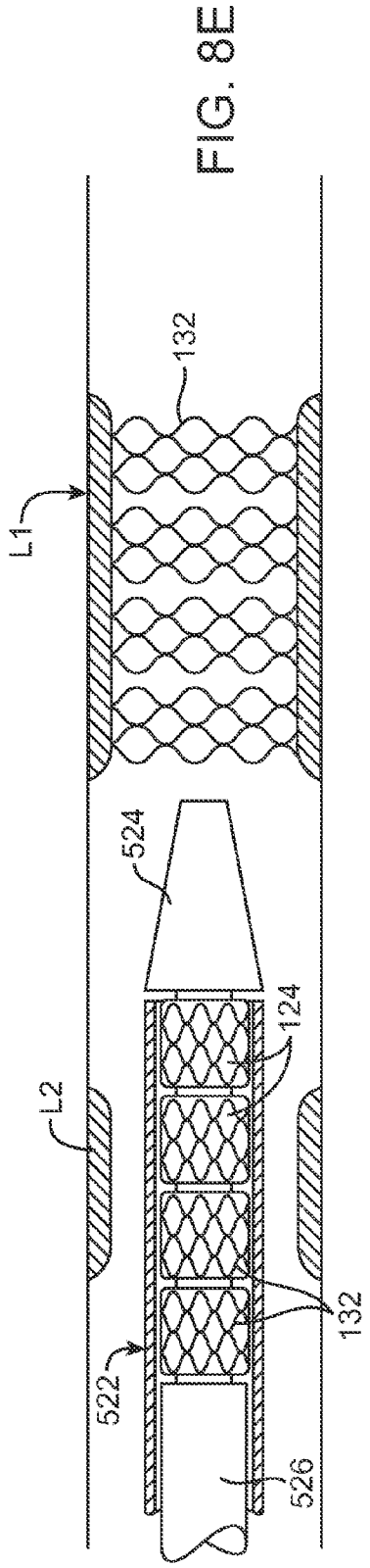

FIG. 8D



CUSTOM-LENGTH STENT DELIVERY SYSTEM WITH INDEPENDENTLY OPERABLE EXPANSION ELEMENTS

CROSS-REFERENCES TO RELATED APPLICATIONS

[0001] The present application is a continuation of U.S. patent application Ser. No. 10/104,305 (Attorney Docket No. 021629-003300US), the entire contents of which are incorporated herein by reference.

BACKGROUND OF THE INVENTION

[0002] The present invention relates generally to systems and methods for deploying stents at one or more treatment sites. More specifically, the invention relates to systems and methods for delivering multiple stents of various lengths to multiple treatment sites using a single device.

[0003] Stenting has become an increasingly important treatment option for patients with coronary artery disease. Stenting involves the placement of a tubular prosthesis within a diseased coronary artery to expand the arterial lumen and maintain the patency of the artery. Early stent technology suffered from problems with restenosis, the tendency of the coronary artery to become re-occluded following stent placement. However, improvements in stent design and the advent of drug-eluting stents have reduced restenosis rates dramatically. As a result, the number of stenting procedures being performed in the United States, Europe, and elsewhere has soared.

[0004] Stents are delivered to the coronary arteries using long, flexible vascular catheters typically inserted through a femoral artery. For self-expanding stents, the stent is simply released from the delivery catheter and it resiliently expands into engagement with the vessel wall. For balloon expandable stents, a balloon on the delivery catheter is expanded which expands and deforms the stent to the desired diameter, whereupon the balloon is deflated and removed.

[0005] Current stent delivery technology suffers from a number of drawbacks. For example, current stent delivery catheters are not capable of customizing the length of the stent in situ to match the size of the lesion to be treated. While lesion size may be measured prior to stenting using angiography or fluoroscopy, such measurements may be inexact. If a stent is introduced that is found to be of inappropriate size, the delivery catheter and stent must be removed from the patient and replaced with a different device of correct size.

[0006] Moreover, current stent delivery devices cannot treat multiple lesions with a single catheter. Current devices are capable of delivering only a single stent with a single catheter, and if multiple lesions are to be treated, a new catheter and stent must be introduced for each lesion to be treated.

[0007] For these and other reasons, stent delivery systems and methods are needed which enable the customization of stent length in situ, and the treatment of multiple lesions of various sizes, without requiring removal of the delivery catheter from the patient. Such stent delivery systems and methods should further be of minimal cross-sectional profile and should be highly flexible for endovascular positioning through tortuous vascular pathways. Ideally, such stent delivery systems would also allow for accurate and repeatable positioning of one or more stents in a desired position for

deployment from a catheter in situ. At least some of these objectives will be met by the present invention.

BRIEF SUMMARY OF THE INVENTION

[0008] The invention provides stent delivery systems and methods that overcome the challenges outlined above and provide other advantages. The invention enables the delivery of multiple stents from a single catheter during a single intervention, wherein the length of each stent may be customized in situ. In preferred embodiments, the invention provides systems and methods for the delivery of segmented stents, which enable greater control and precision during stent deployment so that optimal stent position and inter-segment spacing are achieved.

[0009] In various embodiments, stent delivery systems and methods are used in stenting of body lumens, typically blood vessels, and more typically coronary arteries. The methods and systems will also find significant use in the peripheral vasculature, the cerebral vasculature, and in other ducts, such as the biliary duct, the fallopian tubes, and the like. The terms “stent” and “stenting” are defined to include any of the wide variety of expandable prostheses and scaffolds which are designed to be intraluminally introduced to a treatment site and expanded in situ to apply a radially outward force against the inner wall of the body lumen at that site. The stents and prostheses of the present invention commonly comprise a closed or, less preferably, an open lattice structure, and are typically formed from a malleable or elastic metal. When formed from a malleable metal, such as stainless steel, gold, platinum, titanium, and super alloys, the stents will typically be expanded by a balloon which causes plastic deformation of the lattice so that it remains opened after deployment. When formed from an elastic metal, including super elastic metals such as nickel-titanium alloys, the lattice structures will usually be radially constrained when delivered and deployed by releasing the structures from such radial constraint so that they “self-expand” at the target site. The terms “stent” and “stent segments” refer broadly to all radially expandable stents, grafts, and other scaffold-like structures which are intended for deployment within body lumens.

[0010] In a first aspect of the invention, a stent delivery system for delivering a plurality of stent segments to at least one treatment site includes a catheter shaft having a proximal end and a distal end, a plurality of expandable members arranged axially along the catheter shaft near the distal end, a plurality of stent segments, and a selecting mechanism adapted for selecting one or more expandable members for expansion. In this embodiment, each expandable member is expandable independently of at least one other expandable member, and each expandable member has at least one stent segment positioned on it. One or more of the expandable members may be selectively expanded to deploy the one or more stent segments positioned thereon at the treatment site. It should be understood that, in many of the embodiments described herein, the invention will encompass either a plurality of separately constructed expandable elements each separately mounted to the catheter and operated independently of the others, or a single integral expandable element mounted to the catheter that has interior partitions to create a plurality of isolated independently-expandable compartments or segments.

[0011] In a typical embodiment, each of the plurality of expandable members and each of the plurality of stent segments is spaced apart from adjacent expandable members and

stent segments, so that each stent segment can be expanded by each expandable member without interfering with adjacent stent segments. In some embodiments, each stent segment is crimped onto one of the expandable members so as to not be axially slidable along the expandable members. Alternatively, each stent segment may be axially slidable along the expandable members.

[0012] Some embodiments further include an inflation lumen in the catheter shaft and a plurality of apertures in communication with the inflation lumen, with each aperture being further in communication with at least one of the expandable members. In some embodiments, the selecting mechanism then comprises an isolating member movably disposed in the catheter shaft for isolating at least a first of the apertures from at least one other of the apertures. For example, the isolating member may comprise a first axially slidable seal. In one embodiment, the first axially slidable seal is coupled at or near a distal end of a first slidable shaft slidably coupled to the catheter shaft. In some embodiments, the catheter shaft has an inflation lumen therein, the first slidable shaft being disposed within the inflation lumen. Optionally, the selecting mechanism may further include a second isolating member for isolating a second aperture from at least one other aperture. Again, in one embodiment, the second isolating member comprises a second axially slidable seal. This second axially slidable seal may be coupled to a second shaft slidably coupled to the catheter shaft. In some embodiments, the first shaft defines a first lumen, and the second shaft is slidably disposed within the lumen. Optionally, a space between the first and second slidable tubular shafts may define an inflation lumen.

[0013] One alternative embodiment, includes multiple inflation lumens, each of which communicates with one of a plurality of expandable members or with an isolated section or compartment of a single expandable member. A proximal inflation lumen selector, usually including a manifold, is used to select which inflation lumen (or lumens) are used at any one time to expand one or more expandable members. In another alternative embodiment, rather than having multiple, separate expandable members, a stent delivery catheter may have a single, elongate expandable member with multiple septa dividing the balloon into multiple compartments.

[0014] Some embodiments further include at least a first axially movable sheath disposed over at least the expandable members and the stent segments. The system may optionally further include at least a second axially movable sheath disposed over part of the catheter shaft, the expandable members and the stent segments. In such an embodiment, the first sheath may be disposed proximally along the catheter shaft relative to the second sheath, and the first and second sheaths may be adapted to allow one or more selected stent segments to be deployed between the sheaths. In some embodiments, the second sheath is movable distally to allow for deployment of at least one stent segment and proximally to cover one or more of the expandable members from which at least one stent segment has been deployed. Optionally, the system may further include a pusher tube slidably disposed within the sheath and proximal to a proximal-most stent segment to advance and/or maintain an axial position of the stent segments relative to the expandable members.

[0015] In another aspect of the present invention, a stent delivery system for delivering a plurality of stent segments to at least one treatment site includes a catheter shaft having a proximal end and a distal end, a plurality of expandable

members arranged axially along the catheter shaft near the distal end, a plurality of stent segments, and at least a first isolating member movably associated with the catheter shaft for selecting one or more expandable members for expansion. Each expandable member is expandable independently of at least one other expandable member, and each expandable member has at least one stent segment positioned on it. Thus, one or more of the expandable members may be selectively expanded to deploy the one or more stent segments positioned thereon at the treatment site. According to this aspect of the invention, the system may have any of the features described above.

[0016] In another aspect of the present invention, a method for delivering a plurality of stent segments to at least one treatment site first involves positioning a distal portion of a stent delivery catheter device at a first treatment site, the stent delivery catheter having a plurality of expandable members positioned thereto, and each of the expandable members having one or more stent segments positioned on it. The method then involves selecting one or more first expandable members for expansion and expanding only the one or more first expandable members to deploy at least a first stent segment at the first treatment site, while at least a second expandable member and at least a second stent segment on the stent delivery catheter remain unexpanded. In some embodiments, expanding only the one or more first expandable members comprises expanding two or more of the expandable members to deploy at least two of the stent segments.

[0017] Optionally, the method may further involve, after the step of expanding only the one or more first expandable members, expanding the second expandable member(s) to deploy the second stent segment(s). Such an embodiment may further comprise positioning the distal portion of the stent delivery catheter device at a second treatment site before expanding the second expandable member(s). In some embodiments, the method further includes, after the step of expanding the one or more first expandable members, axially repositioning the second stent segment from the second expandable member to a distal expandable member selected from the one or more first expandable members, and expanding the distal expandable member to deploy the second stent segment. Optionally, such a method may further comprise positioning the distal portion of the stent delivery catheter device at a second treatment site before expanding the second expandable member. In one embodiment, the second stent segment is repositioned by an axially movable pusher in the stent delivery catheter device. Some embodiments may further comprise selecting at least a third expandable member and expanding the third expandable member to deploy a third stent segment. Again, such a method may also include positioning the distal portion of the stent delivery catheter device at a third treatment site before expanding the third expandable member.

[0018] In some embodiments, selecting the first expandable member(s) comprises axially moving at least a first sealing member to seal off one or more first inflation apertures communicating with the first expandable member(s) from at least a second inflation aperture communicating with the second expandable member(s). For example, in one embodiment, axially moving the first sealing member comprises sliding a tubular shaft over an inner shaft. In such an embodiment, expanding may comprise introducing an inflation medium into the first expandable member(s) through an inflation lumen between the tubular shaft and the inner shaft. Such

a method may also optionally involve axially moving the first sealing member to seal off the second inflation aperture(s) from at least a third inflation aperture communicating with one or more third expandable members, axially moving a second sealing member to seal off at least one of the first inflation apertures from the second inflation aperture(s), and expanding only the second expandable member(s) to deploy the second stent segment(s). In some embodiments, the first sealing member is coupled to a first shaft, the second sealing member is coupled to a second shaft, and axially moving the first and second sealing members comprises sliding the second shaft relative to the first shaft. For example, the first shaft may be tubular and the second shaft may be slidably disposed through the first shaft. In some embodiments, expanding comprises introducing an inflation medium into the second expandable member(s) through an inflation lumen between the first and second shafts.

[0019] Optionally, the method may further comprise axially moving a first sheath disposed over the expandable members and the plurality of stent segments, before the expanding step, to expose the first expandable member(s) and stent segment(s) while covering the second expandable member(s) and second stent segment(s). The method may further involve contracting the first expandable member(s), moving the first sheath to cover the first expandable member(s), advancing the second stent segment(s) to be positioned on the first expandable member(s), moving the first sheath to expose the second expandable member(s), and expanding the second expandable member(s) to deploy at least the second stent segment(s).

[0020] In some embodiments, the method further includes positioning the distal portion of the stent delivery catheter device at a second treatment site before expanding the second expandable member(s). Such a method may also involve deflating the first expandable member(s), moving a second sheath to cover the first expandable member(s), moving the first sheath to expose the second expandable member(s) and the second stent segment(s), and expanding the second expandable member(s) to deploy the second stent segment(s) while the first expandable member(s) remain covered by the second sheath. Optionally, such a method may further involve positioning the distal portion of the stent delivery catheter device at a second treatment site before expanding the second expandable member(s).

[0021] Other aspects of the nature and advantages of the invention will become apparent from the following detailed description when taken in conjunction with the drawings.

BRIEF DESCRIPTION OF THE DRAWINGS

[0022] FIG. 1 is a perspective view of a stent delivery catheter system, according to one embodiment of the present invention.

[0023] FIGS. 2A and 2B are partial cross-sectional side views of a distal end of a stent delivery catheter system, according to one embodiment of the present invention.

[0024] FIGS. 3A and 3B are partial cross-sectional side views of a distal end of a stent delivery catheter system, according to an alternative embodiment of the present invention.

[0025] FIG. 4 is a partial cross-sectional side view of a distal end of a stent delivery catheter system including a sheath, according to another alternative embodiment of the present invention.

[0026] FIGS. 5A and 5B are side views of a stent delivery catheter system having two sheaths, demonstrating deploy-

ment of two variously sized stent segments, according to one embodiment of the present invention.

[0027] FIG. 6 is a cross-sectional side view of a distal end of a stent delivery catheter system having a movable inner tube with inflation slots, according to another alternative embodiment of the present invention.

[0028] FIGS. 7 and 7A are side and cross-sectional views, respectively, of a stent delivery catheter having multiple inflation lumens, according to one embodiment of the present invention.

[0029] FIGS. 8A-8G are partial cross-sectional side views of a distal end of a stent delivery catheter system, demonstrating a method for delivering multiple stent segments, according to one embodiment of the present invention.

DETAILED DESCRIPTION OF THE INVENTION

[0030] A first embodiment of a stent delivery catheter system 20 according to the present invention is illustrated in FIG. 1. Stent delivery system 20 includes a catheter body 22 comprising an outer sheath 25 slidably disposed over an inner shaft 27. Multiple expandable members 24, preferably inflatable balloons (shown in an inflated configuration), are positioned to inner shaft 27 and are exposed by retracting sheath 25 relative to inner shaft 27. A tapered nosecone 28, composed of a soft elastomeric material to reduce trauma to the vessel during advancement of the device, is positioned distally of expandable member 24. One or more stents 30, comprising a plurality of separate or separable stent segments 32, is disposed on expandable members 24, such that each expandable member 24 has a stent segment 32 positioned on it for expansion therewith. A guidewire tube 34 is slidably positioned through a guidewire tube exit port 35 in sheath 25 proximal to expandable members 24. A guidewire 36 is positioned slidably through guidewire tube 34, expandable members 24, and nosecone 28 and extends distally thereof.

[0031] A handle 38 is positioned to a proximal end 23 of sheath 25 and includes an actuator 40 slidably positioned thereto for purposes described below. An adaptor 42 is positioned to the proximal end of handle 38 and provides a catheter port 44 through which inner shaft 27 is slidably positioned. A flush port 48 is positioned to the side of adaptor 42 through which a fluid such as saline can be introduced into the interior of catheter body 22. An annular seal (not shown) in catheter port 44 seals around inner shaft 27 to prevent fluid from leaking through catheter port 44. Optionally, a clamp (not shown) such as a threaded collar, can be positioned to catheter port 44 to lock inner shaft 27 relative to handle 38. Suitable handles for use with the present invention are further described in U.S. Pat. No. 7,326,236, originally U.S. patent application Ser. No. 10/746,466, filed Dec. 23, 2003 (Attorney Docket No. 021629-002200US), which is hereby incorporated by reference.

[0032] Inner shaft 27 has a proximal end 50 to which is positioned an inflation adaptor 52. Inflation adaptor 52 is configured to be fluidly coupled to an inflation device 54, which may be any commercially available balloon inflation device such as those sold under the trade name "Indeflator™," available from Advanced Cardiovascular Systems of Santa Clara, Calif. Inflation adaptor 52 is in fluid communication with expandable member 24 via an inflation lumen (described below) in inner shaft 27 to enable inflation of expandable member 24.

[0033] Additional aspects of stent delivery devices suitable for use with the present invention are described in U.S. Pat.

No. 7,309,350, originally U.S. patent application Ser. No. 10/637,713 (Attorney-Docket No. 021629-000340US), filed Aug. 8, 2003, and assigned to the assignees of the present invention, the full disclosure of which is hereby incorporated by reference. In preferred embodiments, the geometry, construction, materials and other aspects of stent segments **32** may be similar to those described in copending U.S. patent application Ser. No. 10/738,666, filed Dec. 16, 2003 (Attorney Docket No. 021629-000510US), which is hereby incorporated by reference. The present invention, however, includes a number of alternative and additional features, most significant of which are the multiple, individually inflatable, expandable members of the present invention and the various selection mechanisms employed in various embodiments to provide for individual expansion of the expandable members. These features will be described in further detail below.

[0034] Generally, the various embodiments of stent delivery catheter system **20** provide for independent expansion of expandable members **24** to independently deploy stent segments **24** at one or more treatment sites. By “independent expansion” and “independent deployment,” it is meant that one or more expandable members **24** may be expanded to deploy one or more stent segments **32** while maintaining at least one other expandable member **24** and stent segment **32** thereon in an unexpanded, undeployed configuration. In some embodiments, as in FIG. 1, one or more sheaths **25** may cover unexpanded expandable members **24** and stent segments **32**, while alternative embodiments do not include sheaths. Generally, the system includes some form of selection and/or isolating mechanism, for allowing a user to select one or more expandable members **24** for expansion. Using independently expandable members **24** allows for deployment of one or more stent segments **32** at a first site, followed by deployment of one or more additional segments **32** at a second site, and so on, for any number of lesions. In various alternative embodiments, a single, elongate expandable member having multiple inner septa or partitions to divide the expandable member into multiple separate chambers may be substituted for the multiple expandable members **24** shown in the FIG. 1 embodiment.

[0035] Lesions of various different lengths may be treated by selecting a desired number of expandable members **24** and associated stent segments **32** in situ to deploy at the lesion site. In various embodiments, a wide range of numbers, lengths, and types of stent segments **32** may be deployed, and a corresponding number, length, and type of lesions may be treated. Stent segments **32** have a length suitable for the anatomical location and characteristics of the lesion being treated, usually being about 2-30 mm in length, more typically being about 2-20 mm in length, and preferably being about 2-10 mm in length. In preferred embodiments, each expandable member **24** has an axial length suitable to accommodate one or more stent segments **32**, usually having a length of about 3-65 mm, more typically about 3-25 mm in length, and preferably about 4-15 mm, depending upon the length of stent segments **32** and the number of stent segments **32** mounted on each expandable member **24**. Also the balloon length will be selected to provide the desired amount of balloon overhang (length of balloon not covered by stent) on the proximal and distal sides of each stent segment, usually being less than about 2 mm. Of course, if a single expandable member with separately inflatable compartments is used, its overall axial length would be longer, and the axial length of each compartment would correspond to the above ranges.

Expandable members and stent segments of shorter or longer length are also possible without departing from the scope hereof.

[0036] Stent segments **32** may have any of a variety of common constructions, such as but not limited to those described in U.S. patent application Ser. No. 10/738,666, filed Dec. 16, 2003 (Attorney Docket No. 021629-000510US), which was previously incorporated by reference. Stent segment **32** constructions may include, for example, closed cell constructions such as expandable ovals, ellipses, box structures, expandable diamond structures, expandable rhomboid structures, as well as other regular and irregular polygonal structures, etc. In addition, the closed cells may have complex slotted geometries, such as H-shaped slots, I-shaped slots, J-shaped slots, etc. Suitable open cell structures include zigzag structures, serpentine structures, and the like. Such conventional stent structures are well described in the patent and medical literature. Specific examples of suitable stent structures are described in the following U.S. patents, the full disclosures of which are incorporated herein by reference: U.S. Pat. Nos. 6,315,794; 5,980,552; 5,836,964; 5,527,354; 5,421,955; 4,886,062; and 4,776,337.

[0037] Any number of stent segments **32** may be deployed from stent delivery catheter **20**. Usually, the number of delivered stent segments **32** will be in the range from 2 to 50, more typically from 2 to 25, and preferably from 2 to 10. These correspond to overall deployed stent lengths of about 2-200 mm, more typically 4-100 mm, and preferably 4-60 mm. The multiple segments **32** may be deployed individually or in groups of two or more at a single location or at multiple spaced-apart locations in the body lumen or lumens.

[0038] Stent segments **32** are preferably constructed of a malleable metal so as to be plastically deformable by expandable members **24** as they are expanded to the desired diameter in the vessel. Alternatively, stent segments **32** may be formed of an elastic or super elastic shape memory material such as Nitinol so as to self-expand upon release into the vessel by retraction of sheath **25**. Stent segments **32** may also be composed of polymers or other suitable biocompatible materials. In self-expanding embodiments, expandable member **24** may also be used for predilatation of a lesion prior to stent deployment or for augmenting the expansion of the self-expanding stent segments.

[0039] In some embodiments, stent segments **32** are coated, impregnated, infused or otherwise coupled with one or more drugs that inhibit restenosis, such as Rapamycin, Everolimus, Paclitaxel, analogs, prodrugs, or derivatives of Rapamycin, Everolimus or Paclitaxel, or other suitable agent(s), preferably carried in a durable or bioerodable polymeric carrier. Alternatively, stent segments **32** may be coated with other types of drugs or therapeutic materials such as antibiotics, thrombolytics, anti-thrombotics, anti-inflammatories, cytotoxic agents, anti-proliferative agents, vasodilators, gene therapy agents, radioactive agents, immunosuppressants, chemotherapeutics and/or stem cells. Such materials may be coated over all or a portion of the surface of stent segments **32**, or stent segments **32** may include apertures, holes, channels, or other features in which such materials may be deposited.

[0040] Stent segments **32** are preferably completely separate from one another without any interconnections, but alternatively may have couplings between two or more adjacent segments **32** which permit flexion between the segments **32**. As a further alternative, one or more adjacent stent segments **32** may be connected by separable or frangible couplings that

are separated prior to or upon deployment, as described in copending application Ser. No. 10/306,813, filed Nov. 27, 2002 (Attorney Docket No. 021629-000320US), which is incorporated herein by reference.

[0041] Sheath **25** may have any suitable shape, length, cross-sectional diameter, material thickness, and the like and may be made of any suitable material or combination of materials. In one embodiment, for example, sheath **25** may have a length selected to extend over all of expandable members **24**, in one embodiment being between about 100 cm and about 125 cm. Sheath **25** may be constructed of any of a variety of biocompatible materials, such as but not limited to a polymer such as PTFE, FEP, polyimide, or Pebax, may be reinforced with a metallic or polymeric braid to resist radial expansion of expandable members **24**, and/or the like. Expandable members **24** comprise expandable balloons, which may be formed of a semi-compliant polymer such as Pebax, Nylon, polyurethane, polypropylene, polytetrafluoroethylene (PTFE), or other suitable polymer. Stent segments **32** are positioned at fixed positions on expandable members **24**.

[0042] Referring now to FIGS. 2A and 2B, in one embodiment, a distal end of stent delivery catheter **120**, shown in partial cross-section, includes an inner catheter shaft **127**, a guidewire **136** extending through inner shaft **127**, an outer catheter shaft **156**, a distal nosecone **128**, multiple expandable members **124**, multiple stent segments **132** and a slidable tubular member **160** disposed over inner catheter shaft **127** and coupled near its distal end with a sealing member **162**. Outer catheter shaft **156** forms a catheter shaft lumen **166** and includes multiple inflation apertures **158**, each of which is in fluid communication with catheter shaft lumen **166** and the interior space of one expandable member **124**. An inflation lumen **164** is formed by a space between slidable tubular member **160** and inner catheter shaft **127**.

[0043] Sealing member **162** may be comprised of a resilient or rigid material suitable for forming a seal between itself and the inner surface of outer catheter shaft **156**, such as an elastomer or other resilient material. Thus, when an inflation medium, such as saline, is passed through inflation lumen **164**, into catheter shaft lumen **166**, sealing member confines the inflation medium to the portion of catheter shaft lumen **166** distal to it and to any expandable members **124** distal to it. By moving slidable tubular member **160** axially, as shown in FIGS. 2A and 2B, a number of expandable members **124**, ranging from one to as many as desired, may be selected for inflation and expansion. In FIG. 2B, the two distal-most expandable members **124** have been selected and expanded via inflation medium (solid-tipped arrows), and the two distal-most stent segments **132** have thus been expanded and deployed. In a subsequent deployment, as will be described more fully below, slidable tubular member **160** may be moved again to change the position of sealing member **162**, and one or more additional expandable members **124** may be inflated to deploy one or more additional stent segments **132**. One or more expandable members **124** and/or stent segments **132** thereon may have different expanded diameter, length, geometry, material, coatings and/or other features than other expandable members **124** or stent segments **132**. This way, one or more stent segments **132** may be selected to have the optimum size, shape, material, elution profile, and therapeutic effect for the lesion or part of the lesion being treated.

[0044] In contrast to the embodiment shown in FIG. 1, the embodiment in FIGS. 2A and 2B does not include a sheath. In

an embodiment without a sheath, stent segments **132** may be crimped or otherwise coupled with expandable members **124** relatively tightly or snugly, so that they remain coupled to expandable members **124** during insertion of catheter **120** into a blood vessel. Embodiments without sheaths have the advantages of a smaller profile and reduced stiffness and complexity. Additionally, if stent segments **132** are fixed or crimped onto expandable members **124**, catheter **120** does not require a pusher member or other mechanism for advancing stent segments **132** or holding them in place while a sheath is retracted. At least one alternative embodiment, described further below, does include a sheath, which may be advantageous for protecting stent segments **132** during advancement of the catheter and for other reasons. In embodiments having sheaths, stent segments may be axially slidable along the expandable members, such that segments may be advanced to take up the positions from which stent segments have been deployed.

[0045] Referring now to FIGS. 3A and 3B, an alternative embodiment of a stent delivery catheter **220** includes many of the features described above and also includes an inner tubular member **268** coupled with a distal sealing member **270** and an outer tubular member **260** coupled with a proximal sealing member **262**, with an inflation lumen **264** formed between the two tubular members **260**, **268**. Inner tubular member **268** is disposed between inner catheter shaft **127** and outer tubular member **260** and extends distally out of the latter. Both outer tubular member **260** and inner tubular member **268** are axially slidable relative to each other and to inner catheter shaft **127**. Thus, each tubular member **260**, **268** may be moved separately to position sealing members **262**, **270** to isolate one or more expandable members **124** for expansion.

[0046] As shown in FIG. 3A, tubular members **260**, **268** may first be used to position sealing members **262**, **270** to isolate a distal-most expandable member **124** for expansion (or any other desired expandable member or members **124**), thus deploying a distal-most stent segment **132**. After stent segment **132** is deployed, expandable member **124** is allowed to deflate. As shown in FIG. 3B, outer tubular member **260** and inner tubular member **268** may then be moved proximally to allow distal sealing member **270** and proximal sealing member **262** to isolate one or more additional expandable members **124** for expansion, thus deploying additional stent segments **132**. One advantage of this embodiment is that the combination of proximal sealing member **262** and distal sealing member **270** allows for deployment of additional stent segments **132** without inflating expandable members **124** from which segments **132** have already been deployed. For example, as shown in FIG. 3B, when the additional stent segments **132** are deployed, the distal-most expandable member **124** does not expand, because distal sealing member **270** prevents inflation medium from passing into it. Of course, outer and inner tubular members **260**, **268** and proximal and distal sealing members **262**, **270** may be moved in any desired combination to allow for deployment of stent segments **132** in any desired number, configuration or pattern. For example, in an alternative embodiment, one or more proximal stent segments **132** may be deployed before one or more distal stent segments **132**, stent segments **132** may be deployed one at a time from distal to proximal, groups of stent segments **132** may be deployed all at once, or the like. Thus, the method demonstrated by FIGS. 3A and 3B is but one example of a number of possible deployment methods. Moreover, an annular lumen within inner tubular member **268** may be used to

deliver inflation fluid to any expandable members 124 distal to distal sealing member 270, independently of that delivered via outer tubular member 260. This enables different expandable members 124 to be inflated at different pressures and/or diameters than other expandable members 124, even at the same treatment site.

[0047] With reference now to FIG. 4, in an alternative embodiment, a stent delivery catheter 320 includes a sheath 322 disposed over expandable members 124 and stent segments 132. Sheath 322 typically surrounds stent segments 132 during advancement and positioning of catheter 320, thus protecting segments 132 from possible damage, and then is retracted to expose a desired number of segments 132 for deployment. A single inflation lumen within outer catheter shaft 156 communicates with each expandable member 124 via ports 158. One or more sliding seals (not shown) may optionally be provided within outer catheter shaft 156 to isolate selected ports 158 from other ports 158. A slidable pusher tube 323 is disposed proximal to the proximal-most stent segment 132 to maintain the position of segments 132 during retraction of sheath 322. In some embodiments, pusher tube 323 may also be used to advance stent segments 132 distally along expandable members 124. In such embodiments, segments 132 are more loosely placed over expandable members 124, so as to be slidable along them. Exemplary embodiments of stent delivery catheters having sheaths are described in further detail in U.S. Pat. No. 7,309,350, originally U.S. patent application Ser. No. 10/637,713 (Attorney-Docket No. 021629-000340US), which was previously incorporated by reference.

[0048] In use, sheath 322 is typically positioned over stent segments 132 during advancement of catheter 320 to a treatment site. Sheath 322 is then retracted proximally to expose a desired number of stent segments 132, while pusher tube 323 is maintained in a fixed position to prevent stent segments 132 from moving proximally along expandable members 124 while the sheath is retracted. Inflation fluid is then delivered through the inflation lumen in outer catheter shaft 156 to inflate those expandable members 124 exposed outside of sheath 322. Sheath 322 constrains the remaining expandable members 124 and associated stent segments 132 from expanding. After the exposed stent segments 132 are deployed, the expandable members 124 used to deploy those stent segments 132 are deflated, sheath 322 is then repositioned over the deflated expandable members 124, and pusher tube 323 may be used to advance undeployed stent segments 132 over the deflated expandable members 132. At a second treatment site, the process may be repeated, deploying the same or a different number and/or length of stent segments 132.

[0049] In an alternative embodiment, and with reference now to FIGS. 5A and 5B, a stent delivery catheter device 420 may include a proximal sheath 425 and a distal sheath 426. Proximal sheath 425 and distal sheath 426 are slidably disposed over expandable members 424, and stent segments 432 disposed thereon, when in an unexpanded configuration. Distal sheath 426 is coupled with nosecone 428, and nosecone 428 is coupled with a distal sheath actuator (not shown) slidably disposed within catheter device 420, which is used to axially move distal sheath 426 and nosecone 428 relative to expandable members 424. Proximal sheath 425 extends up to the proximal end of distal sheath 426 from the proximal end of catheter 420 and is slidably disposed over expandable members 424. In various embodiments, proximal sheath 425

may be movable proximally, distally or both. For example, proximal sheath 425 may sometimes be retracted proximally to expose one or more expandable members 424 and one or more stent segments 432 between the two sheaths 425, 426, but in some embodiments may also be advanced distally to cover one or more expandable members 424 and stent segments 432 thereon.

[0050] In use, distal sheath 426 may be moved distally to expose a first expandable member 424a and one or more stent segments 432a disposed thereon, as in FIG. 5A, and may then be repositioned proximally to expose a second plurality of expandable members 424b and one or more stent segments 432b disposed thereon, as in FIG. 5B. Following deployment of stent segments 432a from expandable members 424a, distal sheath 426 may be positioned over expandable members 424a to constrain them from expansion while expandable members 424b are expanded. In this embodiment, as with others described herein, the plurality of expandable members 424 may be replaced by one or more longer expandable members with a plurality isolated, partitioned compartments or segments therein that may be independently expanded.

[0051] Examples of stent delivery devices having multiple sheaths, which may be adapted for use with various embodiments of the present invention are described in copending U.S. patent application Ser. No. 10/686,025 (Attorney Docket No. 021629-002000US), filed Oct. 14, 2003, which is hereby incorporated by reference.

[0052] FIGS. 5A and 5B demonstrate one way in which stent delivery catheter device 420 of the present invention may be used to deliver stents having different lengths and/or different numbers of stent segments 432. In FIG. 5A, distal sheath 426 and proximal sheath 425 are positioned to expose a set of two expandable members 424a and two stent segments 432a. In FIG. 5B, distal sheath 426 and proximal sheath 425 are positioned to expose a different, more proximal expandable member 424b and a corresponding stent segment 432b thereon. Of course, any number of different stent segments may be positioned in fixed positions on expandable members 424, and proximal and distal sheaths 425, 426 may be positioned in any number of combinations to allow a physician to place various stent segments 432 at various locations to treat multiple lesions.

[0053] With reference now to FIG. 6, a distal portion of an alternative embodiment of a stent delivery catheter device includes multiple expandable members 124 and multiple stent segments 132, with each expandable member 124 having one segment 132 positioned on it. Again, in alternative embodiments, catheter device 440 may include one expandable member divided by multiple septa into multiple chambers. Also in alternative embodiments, two or more stent segments 132 may be positioned on each expandable member 124. Many alternative embodiments and combinations may be used.

[0054] In the embodiment shown in FIG. 6, expandable members 124 are disposed axially along an outer catheter shaft 456, which includes multiple, fixed inflation apertures 458, each aperture 458 in communication with the interior space of one expandable member 124. An axially slidable inner inflation tube 442 is slidably disposed within outer catheter shaft 456 and includes multiple inflation slots 448 of gradually increasing axial length, which are in fluid communication with an inflation lumen 450 in the center of tube 442, and a distal cap 446. A seal 444, such as an elastomeric

O-ring, may be included to seal any space between outer shaft 456 and inner tube 442 at or near their distal ends. Optionally, such seals 444 may be provided between each inflation slot 448 to eliminate fluid communication therebetween.

[0055] In the embodiment shown, inflation fluid (solid-tipped arrows), such as saline, is passed into inflation lumen 450. When inner tube 442 is positioned as far distally as possible, only one movable inflation slot 448 is aligned with one fixed inflation aperture 458, thus allowing only a distal-most expandable member 124 to expand. All other fixed inflation apertures 458 are covered by solid portions of inner tube 442, so that inflation fluid cannot pass into the other expandable members. If inner tube 442 is moved more proximally, other movable slots 448 align with other fixed inflation apertures 458, thus allowing for expansion of additional expandable members 124. As with other embodiments described above, this embodiment may be used to expand and deploy a selected number of stent segments 132 to treat lesions of various lengths. The embodiment of FIG. 6 may optionally include one or more sheaths slidably disposed over stent segments 132 and a pusher adapted to advance stent segments 132 distally over expandable members 124, as shown in FIGS. 4, 5A and 5B above.

[0056] FIGS. 7 and 7A show another embodiment of a stent delivery catheter device 620 in side and cross-sectional views, respectively. In this embodiment, catheter device 620 includes a catheter shaft 626 having multiple inflation lumens 640 running axially along its length. The distal end of catheter device 620 includes a nosecone 628 and multiple inflation ports 634, with each inflation lumen 640 ending in one inflation port 634, or a set of inflation ports 634, that communicate (s) with a single expandable member 624. Each expandable member 624, in turn has two stent segments 632 disposed thereon, although in alternative embodiments one segment 632 or more than two segments 632 may be disposed on each expandable member 624. The proximal end of catheter device 620 includes a handle, as previously described in reference to FIG. 1, and an inflation adaptor 622 for connecting to a device for introducing inflation medium into inflation lumens 640. The proximal end of catheter device 620 also includes a manifold 649 communicating with each inflation lumen 640 and with a primary inflation lumen extending through handle 638 from inflation adaptor 622. An inflation lumen selector 650 allows a user to select which lumen (or lumens) will receive inflation medium (such as saline) during a given deployment of stent segment(s) 632. Each position of selector 650 may correspond with a single inflation lumen 640 and single expandable member 624, or in alternative embodiments each selector 650 may correspond with multiple inflation lumens 640 and multiple expandable members 624. For example, a physician may choose to inflate selected expandable members 624 associated with one or more inflation lumens 640 by positioning selector 650 at a first numbered position during a first deployment at a first treatment site, and then may select a different inflation lumen 640 corresponding to a different numbered position of selector 650 for a second deployment at a second site. Of course, any number of inflation lumens 640 may be included, in various embodiments, and various inflation lumen selectors 650 may be included at the proximal end of catheter device 620, such as manifolds, switches or the like.

[0057] Referring now to FIGS. 8A-8G, one embodiment of a method for deploying multiple stent segments 132 at two lesions L1, L2 in a vessel V is shown schematically. As

demonstrated in FIG. 8A, to begin a stent deployment, a distal end of a stent delivery catheter device 520 is advanced to a desired location in the vessel V, within a first lesion L1, with an atraumatic nosecone 524 helping prevent damage to the vessel during advancement. A sheath 522 is then retracted proximally (solid-tipped arrow). In FIG. 8B, sheath 522 has been retracted to expose four expandable members 124, each carrying one stent segment 132. The four exposed expandable members 124 are then inflated with inflation fluid, as shown in FIG. 8C, thus expanding and deploying stent segments 132. As shown in FIG. 8D, the four expandable members 124 are then deflated, leaving the deployed stent segments in place within the first lesion L1.

[0058] FIG. 8E shows sheath 522 in cross section, to demonstrate that as a next step, expandable members 124 that were used in the first deployment may be retracted back into sheath 522 or sheath may be advanced over the deflated expandable members 124. A pusher tube 526 may then be used to advance stent segments 132 axially along expandable members 124 to cover the four already-used, distal-most expandable members 124 with stent segments 132. Before, after or during these steps, stent delivery catheter 520 may be repositioned within a second lesion L2, and the method just described may be repeated. As shown in FIG. 8F, sheath 522 may now be retracted to expose two expandable members 124 and stent segments 132. Expandable members 124 may then be expanded, as in FIG. 8G, to deploy the two stent segments 132 in the second lesion L2. Using this technique, any number of stent segments may be deployed in any combinations to treat any number of lesions having any combinations of lengths. In some embodiments, in fact, multiple, differently sized lesions in multiple vessels may be treated.

[0059] While the above is a complete description of the preferred embodiments of the invention, various alternatives, modifications, additions, and substitutions are possible without departing from the scope thereof, which is defined by the claims.

What is claimed is:

1. A stent delivery system for delivering a plurality of stent segments to at least one treatment site, the system comprising:

an outer shaft having a proximal end, a distal end, a central lumen extending therebetween and a plurality of apertures in communication with the central lumen;

a plurality of expandable members arranged axially along the outer shaft near the distal end, wherein each expandable member is in fluid communication with the central lumen and wherein each aperture is in communication with at least one of the expandable members;

a plurality of stent segments, each expandable member having at least one stent segment positioned thereon, wherein one or more of the stent segments may be deployed independently of one or more other of the stent segments;

an inner shaft slidably disposed in the central lumen; and
a selecting mechanism adapted for selecting one or more expandable members for expansion independently of the other expandable members, the selecting mechanism comprising an isolating member coupled with a slidable tubular member disposed over the inner shaft, the iso-

lating member having a first axially slidable seal movably disposed in the outer shaft for isolating at least a first of the apertures from at least one other of the apertures, wherein an inflation lumen is defined by the annular space between the inner shaft and the slidable tubular member, the inflation lumen in communication with the central lumen and adapted to provide an inflation fluid to the plurality of expandable members.

2. A system as in claim 1, wherein each expandable member is expandable independently of at least one other expandable member.

3. A system as in claim 1, wherein the inner shaft comprises a guidewire lumen adapted to slidably receive a guidewire.

4. A system as in claim 1, wherein each stent segment is crimped onto one of the expandable members so as to not be axially slidable along the expandable members.

5. A system as in claim 1, wherein each stent segment is axially slidable along the expandable members.

6. A system as in claim 1, wherein the first axially slidable seal is coupled near a distal end of the slidable tubular member.

7. A system as in claim 6, wherein the slidable tubular member is disposed within the central lumen.

8. A system as in claim 1, further including a second isolating member for isolating a second aperture from at least one other aperture.

9. A system as in claim 1, further including at least a first axially movable sheath disposed over at least some of the expandable members and some of the stent segments.

10. A system as in claim 9, further including at least a second axially movable sheath disposed over part of the outer shaft, the expandable members and the stent segments, wherein the first sheath is disposed proximally along the catheter shaft relative to the second sheath, and wherein the first and second sheaths are adapted to allow one or more selected stent segments to be deployed between the sheaths.

11. A system as in claim 10, wherein the second sheath is movable distally to allow for deployment of at least one stent segment and proximally to cover one or more of the expandable members from which at least one stent segment has been deployed.

12. A system as in claim 9, further including a pusher tube slidably disposed within the sheath and proximal to a proximal-most stent segment to advance or maintain an axial position of the stent segments relative to the expandable members.

* * * * *