

SKANSKA



STRABAG

Working in
partnership with

HS2

Canterbury Works Site

Online community update – February 2022

Agenda

Item	Topic	Lead
1.	Welcome	SCSJV
2.	Works update	SCSJV
3.	Questions	SCSJV and HS2
4.	Meeting ends	SCSJV



Housekeeping

- Please remain on mute while our presenters are speaking
- Please use the chat box or raise your hand to ask questions
- Our community engagement team will take note of all questions
- Specialists on the call tonight can cover questions about items on the agenda



Quick guide for attendees

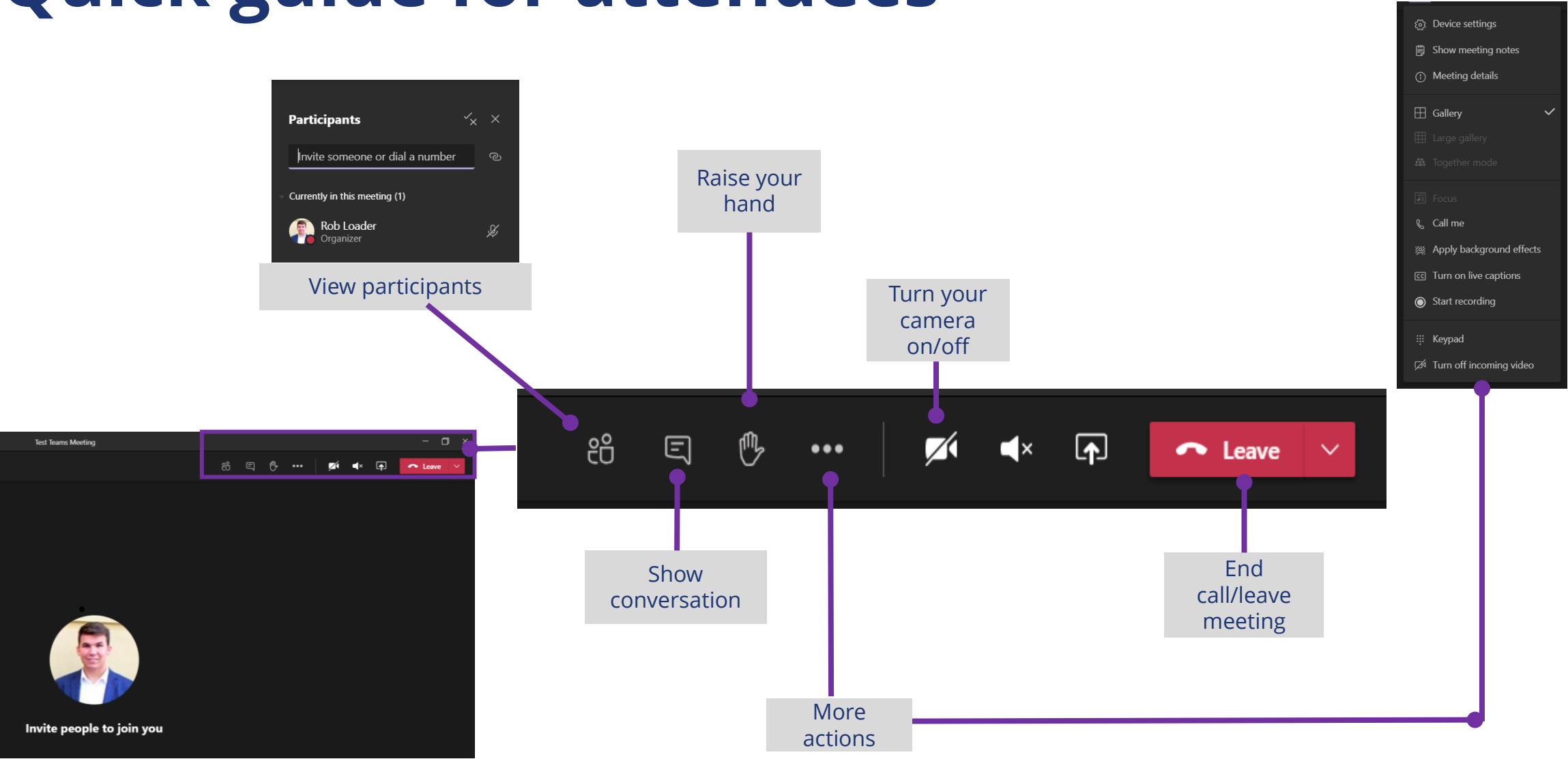

What we will build at the Canterbury Works site

We will build a ventilation shaft and headhouse at the Canterbury Works site in South Kilburn

The headhouse will be above ground

Ground level

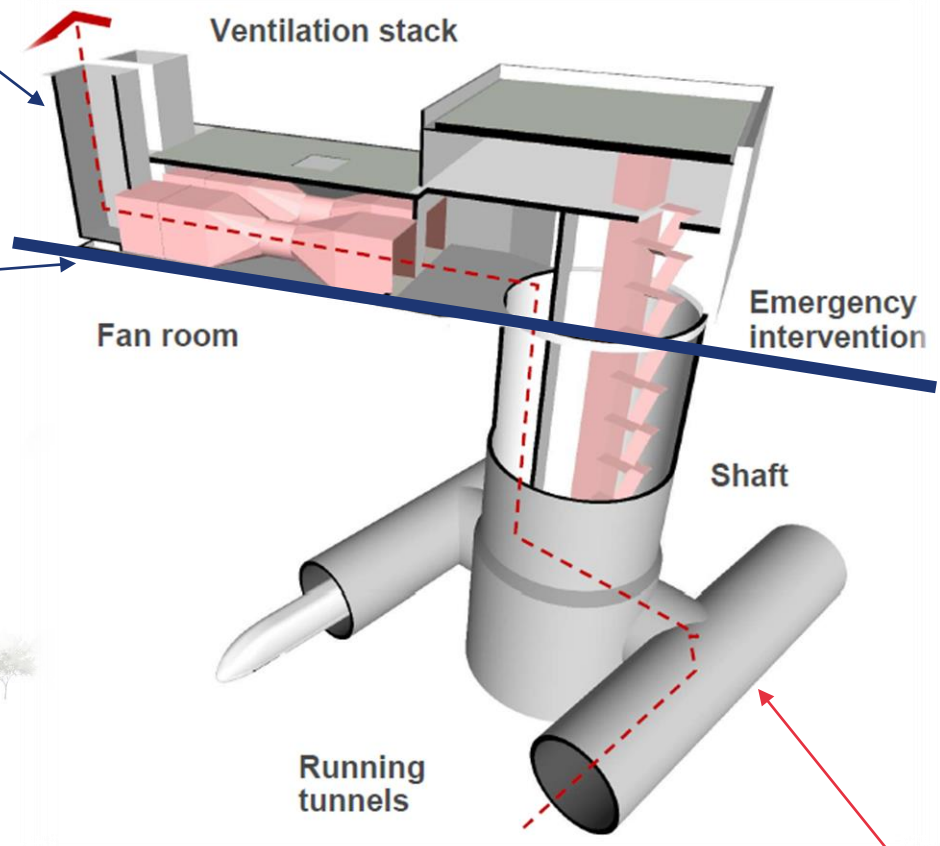

The ventilation shaft and HS2 tunnels will be below ground



Visualisation of Canterbury Works headhouse and compound



Elevated view from St Mary's Primary School / Canterbury House

Indicative construction programme

Construction activity	Planned dates for this activity *
Construction of ventilation shaft	Summer 2021 – Spring 2024
Construction of headhouse	Spring 2023 – Mid 2025
External works including landscaping	Early 2024 – Spring 2025
Completion of works	Late 2025

*the dates for these works may change. We'll provide updates at www.hs2.org.uk/in-your-area/map

Works update: minimising disruption to you

Continuing to monitor noise, dust and vibration in line with the HS2 Code of Construction Practice and review of construction methods when required

Additional attended (hand held) vibration monitoring during works as required

Dust suppression sprays on works and haul roads / a road sweeper will be mobilised on local streets

Operation of additional water bowsers during hot and dry weather

Covering materials, deliveries or loads entering and leaving sites

Machinery on our sites must meet:
Euro Stage IIIB emission standard
From 2022, Euro Stage IV

Construction vehicles on our sites must meet:
Heavy Goods Vehicles – Euro VI
Light Duty Vehicles – Euro 6 (diesel),
Euro 4 (petrol)

The use of acoustic blankets to dampen noise where possible

Sections of flood lights are on isolators – lights can be switched on or off dependent on work being carried out



Going electric

The construction of the Canterbury Works site requires a substantial amount of works which require the use of a crane.

We are now using an electric crane on site.

The benefits from using an electric crane over a diesel crane are as follows:

- Zero emissions (Better for the environment)
- Reduced noise (Less disruption to the local community)



Current / upcoming works until April 2022- Canterbury Works site

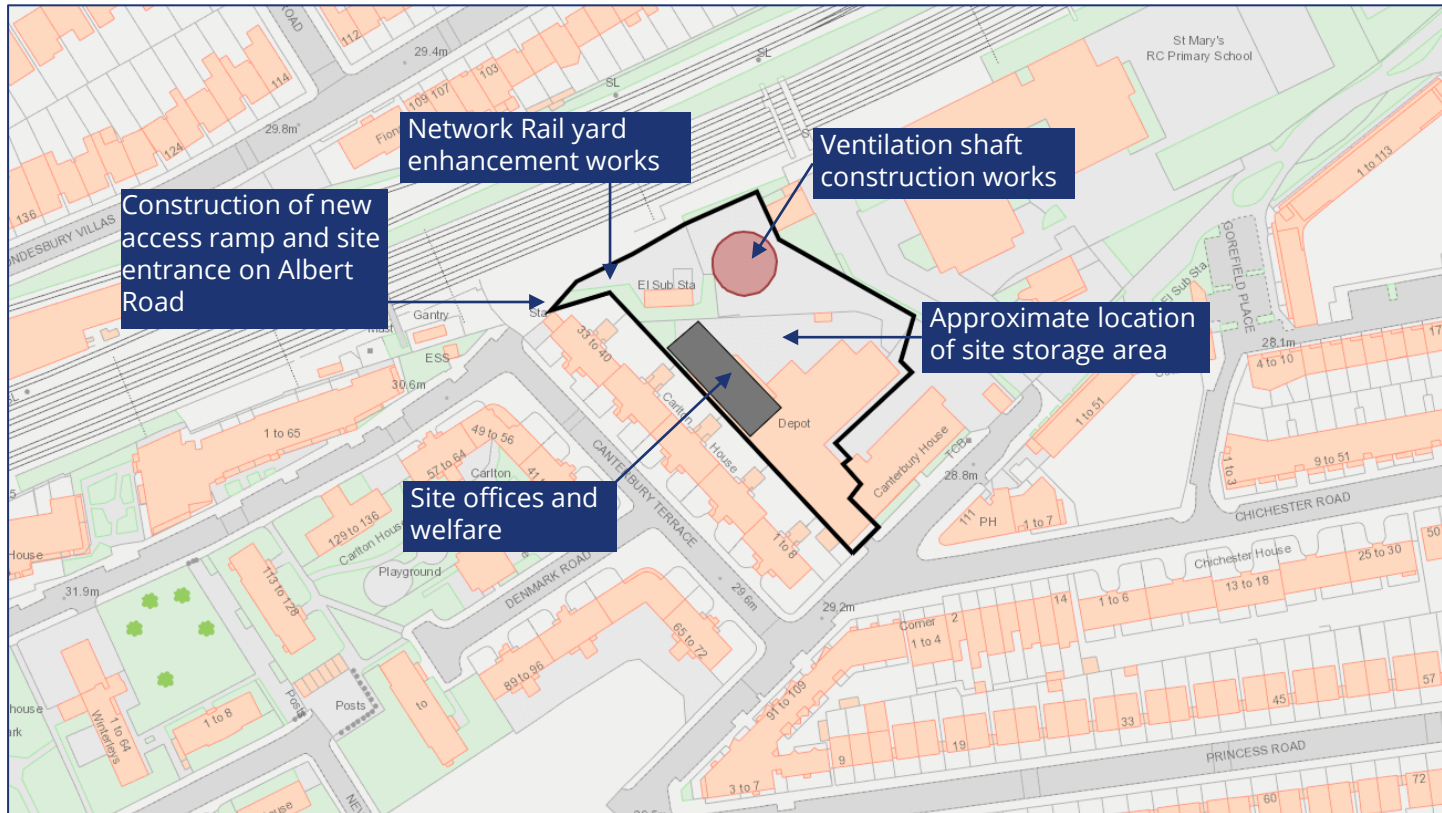

Works are continuing to build the ventilation shaft. Our ongoing and upcoming works are:

- Ongoing works to build the ventilation shaft including excavation, concrete pours and sprayed concrete lining*
- Ongoing works to create working platforms
- On-site storage facilities and removal of excavated materials
- Utility site connections
- Network Rail yard enhancement works including new site entrance on Albert Road
- Utility surveys in the local area

*To carry out aspects of these works, extended working hours will be required. We'll provide further information to our neighbours about these works and provide updates at www.hs2.org.uk/in-your-area/map

Ongoing Construction of the ventilation shaft

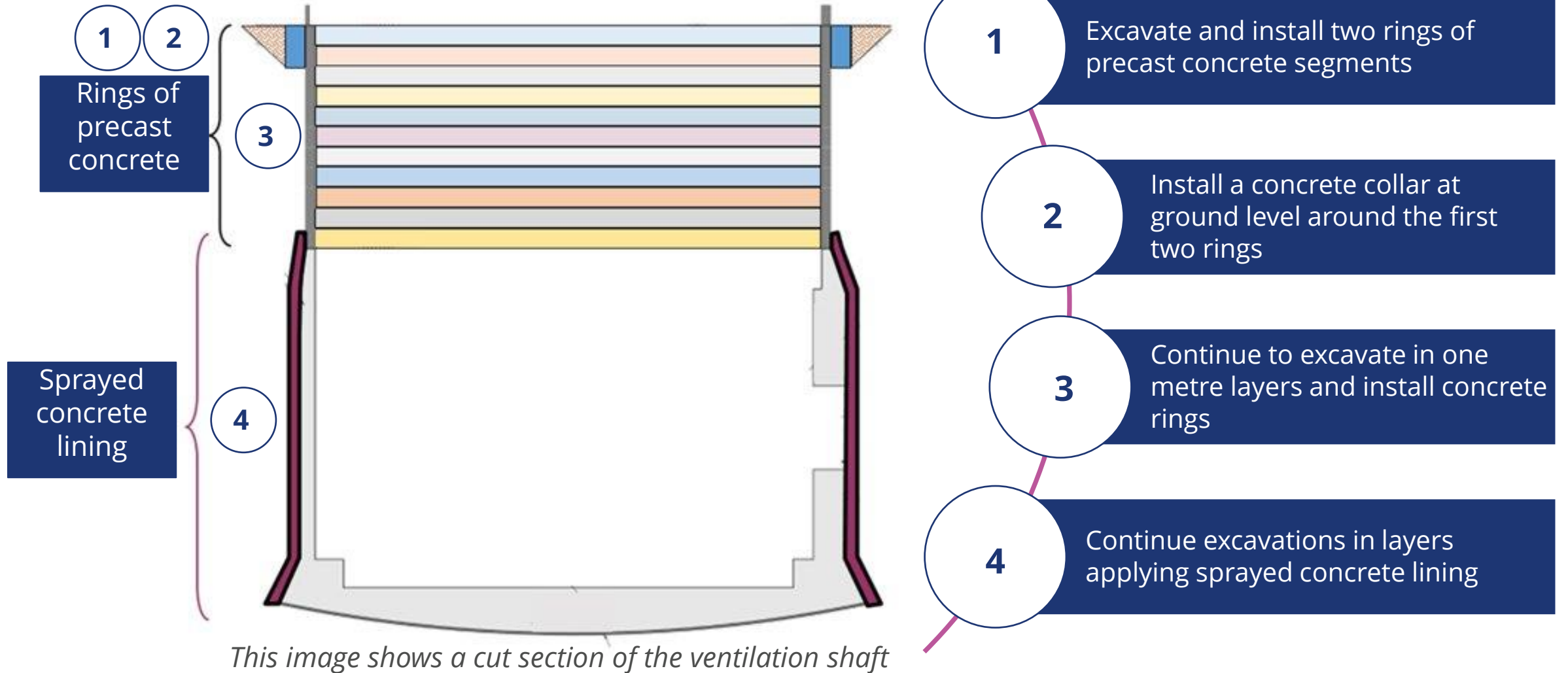

Extended working hours

From March 2022 works will begin to apply sprayed concrete lining (SCL) within the ventilation shaft.

The SCL and shaft excavation works will take place throughout the day and night. This must be carried out as a continuous process to avoid collapses and ensure the safety of the workforce within the ventilation shaft during construction.

From March 2022 we will be permitted to carry out works 24 hours a day, five days a week*. We will only carry out works agreed with Brent Council and will adhere to the agreed working hours, noise and vibration limits.

To help minimise disruption during extended hours we have/will:

- Taken lessons learnt from other HS2 sites
- Prohibit lorry movements outside of core hours
- Carry out 24-hour noise monitoring
- Implement noise training to site team working nights
- Use of electric crane
- Stop the use of reversing plant and machinery



* Times of works will vary throughout these hours.

May 2022 to May 2023 works lookahead*

Duration of works	Description of works
May 2022 to May 2023	<p>These works will include:</p> <ul style="list-style-type: none">• Construction of new site entrance on Albert Road including the construction of a new access ramp and improvements to the Carlton House retaining wall• Utility diversion works and sewer lining• Ongoing works to build the ventilation shaft including excavation, sprayed concrete lining and waterproofing *• Construction of base slab within ventilation shaft• Installation of internal shaft structures (Walls/floors/stairs) from January 2023• Works to build adits (horizontal passages below ground) that will connect the HS2 tunnels*• Installation of Shaft attenuation tank (a storage system for rainwater and surface water) <p>*To carry out these works, extended working hours will be required. We'll provide further information to our neighbors about these works and provide updates at www.hs2.org.uk/in-your-area/map</p>



*Dates and works programmes may change. We'll keep residents updated about our works and provide updates at www.hs2.org.uk/in-your-area/map

Site pictures



Overview of Canterbury Works site



View of excavation inside the ventilation shaft



Precast concrete rings for ventilation shaft



Keeping you informed

We have various ways to keep residents informed:

- You can sign up to our monthly virtual one to one sessions:
 - The next virtual one to one sessions will be on Wednesday 16 March 2022 between 3pm to 6pm
- Community webpage – HS2.org.uk
- 3 and 12 month lookaheads
- Community meetings – the latest community meetings can be found at www.hs2.org.uk/events/

Works notifications

- These can be found on our interactive map: www.hs2.org.uk/in-your-area/map



Any questions?



Thank you for attending.

