

# Find your genius



UNIVERSITY  
of Prince Edward  
ISLAND

# Table of Contents





- 4** TAKE YOUR NEXT STEP WITH THE UNIVERSITY OF PRINCE EDWARD ISLAND
- 5** TEN THINGS STUDENTS LOVE ABOUT UPEI
- 6** PRINCE EDWARD ISLAND IS SPECIAL
- 7** EVERYBODY KNOWS EVERYBODY
- 8** HOW MUCH DOES IT COST?
- 9** FINANCIAL SUPPORT: SCHOLARSHIPS, AWARDS, AND BURSARIES
- 10** WHERE WILL I LIVE?
- 11** UPEI RESIDENCE EXPENSES
- 12** WHAT SUPPORT SERVICES ARE AVAILABLE TO ME?
- 14** ACADEMIC ASSISTANCE
- 15** HOW CAN I GET INVOLVED AND CONNECT WITH OTHER STUDENTS?
- 16** I AM AN INTERNATIONAL STUDENT: WHY SHOULD I CHOOSE UPEI?
- 18** UPEI ATHLETICS AND RECREATION, FITNESS, AND WELLNESS
- 19** UPEI IS THE PLACE TO BE
- 20** WHAT PROGRAMS DOES UPEI OFFER?
- 29** A PERFECT PLACE TO LEARN
- 30** FACULTY AND PROGRAM INDEX
- 36** A LOOK INTO YOUR FUTURE
- 37** APPLY TO UPEI TODAY
- 38** FROM APPLICATION TO FIRST DAY OF CLASS
- 40** CAMPUS MAP
- 42** NOTES



# Take your next steps with the University of Prince Edward Island

Choosing your future path is one of the most important decisions you will make. It's a leap of faith.

We can help. Because at UPEI, your student experience is exactly what you want it to be.

And that experience begins right here, right now. Let us walk you through everything you need to know, and everything you can do as a UPEI student—from the application process, to choosing your program of study, to your first day of classes, and your graduation on Convocation Day.

It's time to take your next step with the University of Prince Edward Island.

Our interesting and unique programs are designed to bring out your best, lead you to discover new and hidden talents—and ultimately—be great at what you do.

Find your genius at **UPEI!**



# TEN THINGS STUDENTS LOVE ABOUT UPEI

## SMALL CLASS SIZES:

UPEI's **17 to 1** student-faculty ratio helps you build close relationships with professors who know your name and care about your academic and personal success.

## DIVERSE LEARNING ENVIRONMENTS:

One-third of our students come from **96 countries**, offering their unique and valuable perspectives and experiences.

## COMPETITIVE TUITION COSTS:

UPEI's undergraduate tuition is lower than many other universities in Canada, with over **\$11M** in student scholarships and awards!

## TRULY GLOBAL PRESENCE:

UPEI campuses include our historic **137-acre** site in Charlottetown; our Canadian Centre for Climate Change and Adaptation in St. Peter's Bay, PEI; and our UPEI Cairo Campus in New Cairo, Egypt.

## SAFETY AND CONVENIENCE:

Charlottetown and its surrounding communities offer safe, inclusive, and welcoming places for our students to call home. UPEI's main campus is a short walk or bus ride to Charlottetown's historic downtown and its shops, pubs, parks, and waterfront.

## AWARD-WINNING PROFESSORS AND INSTRUCTORS:

Seven of our faculty members hold prestigious research chair designations, with many others recognized for their research and commitment to teaching.

## EMPLOYMENT OPPORTUNITIES AND CAREER NETWORKING:

Find student jobs in academic and administrative departments. Our Experiential Education, Career Services, Co-operative Education, and Work-integrated Learning staff provide employment-focused programming, resources, and mentoring to help you reach your career goals.

## ABUNDANT WELLNESS, RECREATION, AND SPORTS OPTIONS:

Take advantage of our modern facilities and a wide range of fitness and wellness programming. Of our **187** varsity student-athletes in 2022, **72 (38.5%)** were named **U SPORTS** Academic All-Canadians.

## UNIQUE STUDENT RESEARCH OPPORTUNITIES:

With research income of **\$10.6M** in 2022, UPEI funds amazing projects for our students and faculty—projects that lead to discoveries benefitting our greater society.

## EASY TRAVEL TO AND FROM UPEI:

Your tuition includes a city transit pass, and our central Atlantic Canadian location allows direct, year-round air travel to Toronto and Montreal, and seasonal flights to Ottawa, Hamilton, Kitchener, Edmonton, and Calgary.

# Prince Edward Island is special

The Epekwitnewaq Mi'kmaq, the Indigenous People of Prince Edward Island, call this beautiful island Epekwitk, which means “resting on the waves.” The University of Prince Edward Island recognizes and acknowledges our location on the unceded, ancestral lands of the Mi'kmaq People, in their traditional and current territory of Mi'kma'ki.

Education is a key component of the Truth and Reconciliation Commission of Canada's Calls to Action. UPEI is committed to advancing reconciliation through higher education. As a community, we have started a journey of growth to realize the role we must play in promoting an understanding of Indigenous history and culture and supporting respectful relationships.

PEI may be Canada's smallest province, but it packs a punch. We're known around the world for scenic landscapes, sun-swept beaches, and small-town charm. It's also one of the safest places to live!

And just like our Island home, the University of Prince Edward Island offers an amazing student experience at our historic campus in Charlottetown. Safety, inclusiveness, plus all the amenities of a large city.

**UPEI EMBODIES EVERYTHING GREAT ABOUT PRINCE EDWARD ISLAND.**



# Everybody knows everybody



## Henrietta

**Bachelor of Science in Nursing**  
Stratford, Prince Edward Island



“The smallness of the UPEI campus community ensures that you have access to staff and resources; you are ‘seen’ and do not get lost in the crowd. From my first year, all my instructors and everyone else in the Faculty of Nursing knew me by name, even if I had not been personally involved with them.”

“A unique fact is that on PEI, *everybody knows everybody*, and after a short time, I became a part of the everybody. I got to know most people in the community, and they got to know me as different activities brought us together: neighbourhood, church, children’s schools, sports and recreation, community gardens, and camps. I don’t think you get that in most places.”

Read more about Henrietta’s experience as a student in UPEI’s amazing Bachelor of Science in Nursing program at [upei.ca/henrietta](https://upei.ca/henrietta)



# How much does it cost?



## AN IMPORTANT QUESTION TO ANSWER RIGHT AWAY!

Consider these figures to estimate first-year costs at UPEI.

### UNDERGRADUATE PROGRAM TUITION\*

*Faculties of Arts; Business; Indigenous Knowledge, Education, Research, and Applied Studies (programs under development); Nursing; Science; and Sustainable Design Engineering*

CANADIAN STUDENTS	INTERNATIONAL STUDENTS
<p><b>\$682.80</b> per 3-credit course x 10 courses per year (<i>full-time</i>) = <b>\$6,828</b> per year</p>	<p><b>\$682.80</b> per 3-credit course x 10 courses per year (<i>full-time</i>) + <b>\$8,010</b> international student fee = <b>\$14,838</b> per year</p>

### POST-DEGREE PROGRAM TUITION\*

Bachelor of Education program

CANADIAN STUDENTS	INTERNATIONAL STUDENTS
<p><b>\$682.80</b> per 3-credit course (<i>12-month program</i>) <i>Contact the Faculty of Education for a semester-by-semester breakdown.</i></p>	<p><b>\$682.80</b> per 3-credit course (<i>12-month program</i>) + <b>\$11,862</b> international student fee <i>Contact the Faculty of Education for a semester-by-semester breakdown.</i></p>

### PROFESSIONAL PROGRAM TUITION\*

Doctor of Veterinary Medicine program

CANADIAN STUDENTS	INTERNATIONAL STUDENTS
<p><b>\$14,916</b> (<i>full-time, per year</i>)</p>	<p><b>\$74,804</b> (<i>full-time, per year</i>)</p>

### GRADUATE PROGRAM TUITION

Graduate program tuition varies by program.

**OTHER FEES** may apply to your program of choice. Visit our tuition and fees selector at [upei.ca/fees](https://upei.ca/fees) for detailed information about each program's tuition and associated costs.

*\*Tuition fees above are based on the 2023–2024 academic year.*



# Financial support:

## Scholarships, awards, and bursaries

Your UPEI education is less expensive than many other Canadian universities, especially when you consider the financial support you'll receive. Upon your acceptance to UPEI, you are immediately eligible for a variety of our scholarships, awards, and bursaries.

The *Celebrating Student Achievement* award program automatically awards guaranteed entrance scholarships of up to **\$3,000** to domestic students with an admissions average over **80%**.

Admissions Average	Guaranteed Entrance Scholarship
95–100%	<b>\$3,000</b>
90–94%	<b>\$2,000</b>
85–89%	<b>\$1,000</b>
80–84%	<b>\$500</b>

New domestic students can apply for more than 40 *Entrance Award Cycle* awards with one simple online application, and new international students may be eligible for our *International Entrance Cycle* awards. **Apply before the March 1 deadline!**

[upei.ca/entrance-awards](https://upei.ca/entrance-awards)

## SCHOLARSHIPS AND AWARDS FOR ALL YEARS, ALL PROGRAMS

*Academic Excellence Awards* reward all students' academic achievements. Based on your previous year's average, you can qualify for awards of **\$500–\$3,000**.

Generous *donor-supported* awards are available to students in all programs at UPEI, with many awards based on financial need. Talk to our Scholarships and Awards Office staff!

PEI students entering their first year at UPEI also qualify for the:

- **GEORGE COLES BURSARY:** **\$3,000** per year, for up to four years (*full-time students*)
- **ISLAND ADVANTAGE BURSARY:** **\$500–\$3,000**, based on financial need

[upei.ca/scholarships](https://upei.ca/scholarships)



# Where will I live?

On campus, with a homestay family, or off campus—all have advantages!

## UPEI RESIDENCE



[upei.ca/residence](https://upei.ca/residence)

Living in residence at UPEI means you're joining a community of friends you will have forever!

UPEI offers all types of accommodations in four modern and comfortable residence buildings:

- **Bernardine Hall:** traditional residence living
- **Bill and Denise Andrew Hall:** two- and three-bedroom suites
- **Blanchard Hall:** two-bedroom apartments for students 19+
- **New residence building:** two- and three-bedroom suites with 40 accessible-living units

## HOMESTAY



[upei.ca/homestay](https://upei.ca/homestay)

Homestay offers students a cultural and linguistic experience and a comfortable, safe place to live with a PEI family! Learn all about Prince Edward Island and experience Canadian culture with our trusted homestay hosts.

**\$900** per month

## OFF-CAMPUS HOUSING



[upei.ca/offcampushousing](https://upei.ca/offcampushousing)

UPEI's Off-Campus Housing Office manages accommodation listings for students and can help you find a place to live outside our residence options.

Rooms with shared bathroom:	<b>\$500–\$850</b> per month
Rooms with private bathroom:	<b>\$700–\$1,200</b> per month
Bachelor apartment:	<b>\$596</b> per month*
One-bedroom apartment:	<b>\$836</b> per month*
Two-bedroom apartment:	<b>\$1,088</b> per month*
Three- or more bedroom apartment:	<b>\$1,167</b> per month*

\*Canada Mortgage and Housing Corporation average rent without utilities in Charlottetown, 2021

# UPEI RESIDENCE EXPENSES



## BERNARDINE HALL

Single room with 5-day meal plan:	<b>\$6,259</b> per semester
Single room with 7-day meal plan:	<b>\$6,315</b> per semester
Double room with 5-day meal plan:	<b>\$5,502</b> per semester
Double room with 7-day meal plan:	<b>\$5,558</b> per semester

## BILL AND DENISE ANDREW HALL

Single suite with 5-day meal plan:	<b>\$6,629</b> per semester
Single suite with 7-day meal plan:	<b>\$6,685</b> per semester
Double suite with 5-day meal plan:	<b>\$6,444</b> per semester
Double suite with 7-day meal plan:	<b>\$6,500</b> per semester
Triple suite with 5-day meal plan:	<b>\$6,444</b> per semester
Triple suite with 7-day meal plan:	<b>\$6,500</b> per semester

## BLANCHARD HALL

Semi-private ( <i>private bedroom</i> ):	<b>\$3,579</b> per semester
------------------------------------------	-----------------------------

## NEW RESIDENCE BUILDING

Single apartment:	<b>\$4,100</b> per semester
Two-bedroom suite ( <i>private bedroom</i> ):	<b>\$3,700–\$3,900</b> per semester
Two- or three-bedroom apartment ( <i>private bedroom</i> ):	<b>\$3,900–\$4,100</b> per semester
Double apartment ( <i>shared bedroom with one other student</i> ):	<b>\$3,200–\$3,500</b> per semester

## SECURITY DEPOSIT **\$300**

5-day meal plan:	<b>\$2,777</b> per semester
7-day meal plan:	<b>\$2,833</b> per semester

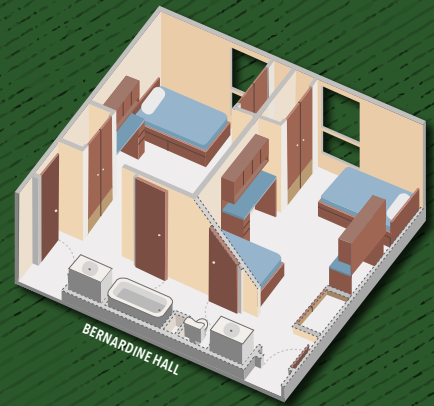

# What support services are available

Our personal and academic support programs are led by considerate faculty, helpful staff members, and compassionate students—starting on your first day!



Visit the **Student Experience Hub** in Dalton Hall for

- **personal counselling:**

[upei.ca/counselling](https://upei.ca/counselling)

- **accessibility and academic accommodation:**

[upei.ca/accessibility](https://upei.ca/accessibility)



The **UPEI Health and Wellness Centre's** caring health professionals provide safe, inclusive, and confidential health services to students, staff, faculty, and their families.

[upei.ca/health-centre](https://upei.ca/health-centre)



UPEI's **Adult ADHD Clinic** works with individuals to assess and treat undiagnosed attention deficit hyperactivity disorder (ADHD) in adults.

[upei.ca/adhd-clinic](https://upei.ca/adhd-clinic)



The **Chaplaincy Centre** provides a multid denominational and inclusive location to meet, eat, socialize, pray, and hold religious services. It is also home to the Campus Food Bank.

[upei.ca/chaplaincy](https://upei.ca/chaplaincy)

to me?



The **Sexual Violence Prevention and Response Office** is a safe and confidential space where students, staff, and faculty who have experienced sexual violence anywhere, and at any time, can obtain support.

[upei.ca/svpro](https://upei.ca/svpro)



The **Mawi'omi Indigenous Student Centre** supports Indigenous students by offering academic advising as well as nurturing the cultural, social, and physical aspects of their journey at UPEI.

[upei.ca/mawiomi](https://upei.ca/mawiomi)



Tanner

**Bachelor of Arts in Diversity  
and Social Justice Studies**  
Goose River, Prince Edward Island



“I chose Diversity and Social Justice Studies at UPEI because I wanted to study where I could put my knowledge to use in a community that I know. I’ve been able to give back to the local Queer community by helping at fundraisers, taking part in seminars and rallies, and volunteering with groups like the Peers Alliance youth group. And I’ve built connections with great people including community leaders and people in high government positions.”

Read how Tanner’s experience in UPEI’s Diversity and Social Justice Studies program inspired them to advocate and support their community at [upei.ca/tanner](https://upei.ca/tanner)



# Academic assistance

As a new student, you can visit the **First-Year Advisement Centre** to register early, navigate course requirements, and receive in-depth academic planning. [upei.ca/firstyearadvisement](https://upei.ca/firstyearadvisement)

At **Student Affairs and the Webster Centre for Academic Success**, you'll find all kinds of academic support services! [upei.ca/student-affairs](https://upei.ca/student-affairs)

- **Gateway Program:**  
[upei.ca/gateway](https://upei.ca/gateway)
- **Tutoring:**  
[upei.ca/tutoring](https://upei.ca/tutoring)
- **Writing Centre:**  
[upei.ca/writingcentre](https://upei.ca/writingcentre)
- **One-on-one mentoring and coaching:**  
[upei.ca/mentoring](https://upei.ca/mentoring)
- **Pathways to Academic Success (PAS):**  
[upei.ca/pas](https://upei.ca/pas)
- **Subject-based help centres:**  
[upei.ca/helpcentres](https://upei.ca/helpcentres)

The **Robertson Library** team has a wealth of knowledge and information to support your learning. The Library is a hub of research and study expertise! [upei.ca/library](https://upei.ca/library)

**Interested in research?** UPEI's faculty members and researchers received **\$10.6 million in research income in 2022**, with many projects involving students! [upei.ca/research](https://upei.ca/research)

Be ready for your career with **UPEI's Experiential Education department and work-integrated Learning office!** [upei.ca/exed](https://upei.ca/exed)

- **Co-operative education:**  
[upei.ca/co-op](https://upei.ca/co-op)
- **Work-integrated learning:**  
[upei.ca/wil](https://upei.ca/wil)
- **Career planning:**  
[upei.ca/careerservices](https://upei.ca/careerservices)
- **Professional mentorship and networking:**  
[upei.ca/upeiconnect](https://upei.ca/upeiconnect)



*Ehimen*

**Bachelor of Business Administration**  
Lagos, Nigeria

“Because of the co-operative education internship in my business program at UPEI, I’ve received real-life, paid work experience in the marketing field and business in general. Many other UPEI programs have co-op education, and I would advise first-year students to consider it. It is the best decision I ever made! I now feel confident entering the job market after I graduate.”

Read more about Ehimen's goals in the music industry and his experiences as a Business student at [upei.ca/ehimen](https://upei.ca/ehimen)



# HOW CAN I GET INVOLVED AND CONNECT WITH OTHER STUDENTS?

Your University of Prince Edward Island experience is full of options and possibilities. UPEI is the place for you to grow beyond the classroom and find what makes you exceptional!

## NSO (NEW STUDENT ORIENTATION)

 [upei.ca/nso](https://upei.ca/nso)

A week-long welcome to UPEI for new students!

## GET INVOLVED!

 [upei.ca/be-involved](https://upei.ca/be-involved)

- **UPEI Student Union** (*student council, student societies and clubs, and social events!*): [upeisu.ca](https://upeisu.ca)
- **Campus Life Program**: [upei.ca/campuslife](https://upei.ca/campuslife)
- **International Buddy Program**: [upei.ca/buddyprogram](https://upei.ca/buddyprogram)
- **Student jobs**: [upei.ca/careerservices](https://upei.ca/careerservices)

## STUDY ABROAD

 [upei.ca/studyabroad](https://upei.ca/studyabroad)

Studying in another country for UPEI credits is one of the most rewarding experiences a student can have! Explore places you've always wanted to visit, take unique courses, gain independence, and make new friends from around the world.

## AFTER CLASS

UPEI's campus has everything you need to relax, meet your friends, or take a study break!

- **Wanda Wyatt Dining Hall**: [dineoncampus/upei](https://dineoncampus/upei)
- **Robertson Library**: [upei.ca/library](https://upei.ca/library)
- **Panther varsity and club team games and intramural sports**: [upei.ca/ar](https://upei.ca/ar)
- **UPEI Residence events**: [upei.ca/residence](https://upei.ca/residence)
- **The Fox & Crow Campus Pub and Café**: [facebook.com//UPEISUTheFoxandCrow](https://facebook.com/UPEISUTheFoxandCrow)



Carter



Bachelor of Science in Chemistry  
Stratford, Prince Edward Island

“I spent a semester studying abroad in Brussels, Belgium, outside my comfort zone, taking social studies, ethics, and French courses to improve my speaking skills. It was really interesting to take courses in subjects I've never studied before! I spent my weekends travelling (*my favourite trips included Switzerland and Barcelona*) and met so many new friends. I'll never forget how much fun I had with them.”

Read more about Carter's time in Belgium, international study opportunities, and what it's like to be a Bachelor of Science student in Chemistry at [upei.ca/carter](https://upei.ca/carter)



# I am an international student:

## Why should I choose UPEI?

More international students attend UPEI each year, representing over 30 per cent of our total student population! Why should you choose UPEI? We offer a truly Canadian educational experience—and because UPEI is safe, fun, and transformative.

### INTERNATIONAL STUDENT ORIENTATION



At the beginning of each semester, we will tell you all about our support and assistance programs for new international students! If you have questions about starting your degree program, making friends, or student activities, we have the answers.

- **General international student details:** [upei.ca/international](https://upei.ca/international)
- **Immigration information:** [upei.ca/immigration](https://upei.ca/immigration)
- **International Buddy Program:** [upei.ca/buddyprogram](https://upei.ca/buddyprogram)
- **English Language Centre:** [upei.ca/elc](https://upei.ca/elc)



### ADMISSION REQUIREMENTS FOR INTERNATIONAL STUDENTS

- 12 years of elementary and secondary education
- A senior secondary certificate, higher school certificate, or matriculation as defined by your home country
- Demonstrated proficiency in the English language—both written and conversational are required

Review English language requirements at [upei.ca/language-requirements](https://upei.ca/language-requirements). Applicants may be eligible for conditional admission with enrolment in English Academic Preparation (EAP).



## LEARN MORE ABOUT PRINCE EDWARD ISLAND!

Experience Atlantic Canada's culture and hospitality as you embrace PEI as your new home.

 [upei.ca/about-upei](https://upei.ca/about-upei)



## INTERNATIONAL STUDENT OFFICE

 [upei.ca/iso](https://upei.ca/iso)

Talk to us about your application, immigration, language requirements, or life as a UPEI student.

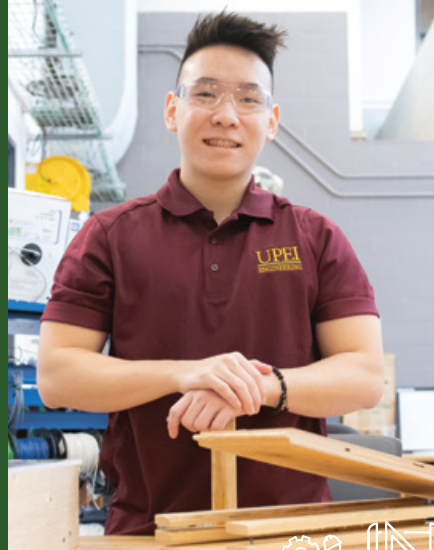

*Yvan*

**Bachelor of Science in Sustainable Design Engineering**  
Port Louis, Mauritius

“Going to a university thousands of miles away from home and family and all that you're familiar with can feel dreadful at the start. However, students in the Sustainable Design Engineering program are blessed to receive a warm welcome every semester in terms of orientation and introduction to available resources.”

Read more about Yvan and his valuable work as a mentor and student success associate in UPEI's Bachelor of Science in Sustainable Design Engineering program at [upei.ca/yvan](https://upei.ca/yvan)





# UPEI ATHLETICS *and* RECREATION, FITNESS, *and* WELLNESS

Eleven Panther varsity teams play in regional Atlantic University Sport (AUS) and national U SPORTS competitions. Panther club teams compete against other regional universities and colleges throughout their respective seasons. Our varsity student-athletes are consistently recognized for their academic and community achievements—72 Panthers were named U SPORTS Academic All-Canadians in 2021–2022!

## VARSITY SPORTS

Basketball (W, M)  
Cross Country (W, M)  
Curling (W, M)  
Ice Hockey (W, M)  
Rugby (W)  
Soccer (W, M)  
Track and Field (W, M)

## CLUB SPORTS

Cheer Team  
Co-ed Ultimate  
Equestrian  
Field Hockey (W)  
Lacrosse  
Rugby (M)  
Swimming (W, M)

**Let recreation be your relaxation!** Physical activity is an important part of your overall wellness. UPEI Athletics and Recreation staff can help you find the perfect outlet for your energy before and after your classes!  [upei.ca/ar](https://upei.ca/ar)

**Fitness classes, yoga, and other classes:**

 [upei.ca/fitness](https://upei.ca/fitness)

**Personal training:**

 [upei.ca/personal-training](https://upei.ca/personal-training)

**Intramural sports:**

 [upei.ca/recreation](https://upei.ca/recreation)

**Athletics facilities:**

 [upei.ca/ar/facilities](https://upei.ca/ar/facilities)

- UPEI Chi-Wan Young Sports Centre
- UPEI Alumni Canada Games Place
- UPEI Artificial Turf Field
- Bell Aliant Centre (Aquatics Facility and MacLauchlan Arena)

**UPEI** is the place to be



Madi

Baccalauréat en éducation (*français langue seconde*)  
Lawrencetown, Nova Scotia



“Compared to other education programs, UPEI is the place to be for continuing my education. UPEI offers a 12-month intensive program which has allowed me to fast-track my dream career in education. Being taught by educators who created the curriculum in PEI provides even more hands-on and applied learning. I have had the opportunity to start my practicum sooner than any other program and use my knowledge in real-life teaching situations.”

Read more about UPEI's unique Bachelor of Education program and Madi's future plans at [upei.ca/madi](https://upei.ca/madi)



# WHAT PROGRAMS DOES UPEI OFFER?

## UNDERGRADUATE PROGRAMS

### Faculty of Arts

An arts degree from UPEI is the perfect start to fulfilling your academic and career aspirations! No matter which program you choose, you will gain the skills you need to succeed in your chosen career. Critical thinking and analysis, clear communications and persuasive argumentation, problem solving and creative conceptualizations—these are but a few competencies you will achieve through your program in the Faculty of Arts.



### ADMISSION REQUIREMENTS

70% minimum cumulative average in five Grade 12 academic subjects including English + one language/social studies + three courses from any academic area

Visit [upei.ca/admission-requirements](https://upei.ca/admission-requirements) for complete requirements for all UPEI programs.

# Faculty of Business

Practical experience, dynamic and innovative courses, and close relationships with research and industry are the cornerstones of a UPEI business education. We provide our students with the knowledge and skills to excel in an ever-changing environment. With fun and meaningful extracurricular opportunities, an active business student society, and ties to community groups and business experts, the Faculty of Business is your launch pad to success.



## ADMISSION REQUIREMENTS

70% minimum cumulative average in five Grade 12 academic subjects including English + math + any two courses from social sciences/sciences/ language + one course from any academic area

Visit [upei.ca/admission-requirements](http://upei.ca/admission-requirements) for complete requirements for all UPEI programs.

# Faculty of Indigenous Knowledge, Education, Research, and Applied Studies

UPEI's Faculty of Indigenous Knowledge, Education, Research, and Applied Studies (IKERAS) brings Indigenous knowledge and ways of doing to the forefront of the University, positioning UPEI as a leading post-secondary institution in Canada in the achievement of Indigenization.



The Minor in Indigenous Studies provides a better understanding of the place and importance of Indigenous history, culture, and knowledge systems.

# Faculty of Nursing

The Bachelor of Science in Nursing program at UPEI ensures you're prepared for your career by combining innovative and interesting classroom study with valuable modern clinical practice experiences. From day one, our students become an important part of a supportive community of peers, instructors, and professors. Learning spaces in the Health Sciences Building are fully equipped with the tools and technologies you will use in your clinical and nursing practice. Each year, students participate in a variety of clinical rotations in health-care facilities around the world. The Faculty of Nursing has a distinguished history of providing exceptional nursing education for all related professions and care settings.



## ADMISSION REQUIREMENTS

65% minimum in each subject with 70% cumulative average in five Grade 12 academic subjects including English + math\*\* + chemistry + biology + one course from any academic area

All applicants to UPEI's Bachelor of Science in Nursing (BSN) programs are required to complete a CASPer assessment (CASPer Test), in addition to meeting academic requirements. Successful completion of CASPer is mandatory to maintain admission eligibility.

\*\*Pre-calculus and/or calculus is recommended.

Visit [upei.ca/admission-requirements](https://upei.ca/admission-requirements) for complete requirements for all UPEI programs.

# Faculty of Science

Solving the scientific challenges of today starts here in the Faculty of Science. Our award-winning professors create a stimulating learning environment in the classroom, the laboratory, and the field. Participate in exciting student activities and scientific conferences, work on innovative research and development projects, and network with faculty members and industry professionals to strengthen your future academic and career prospects.

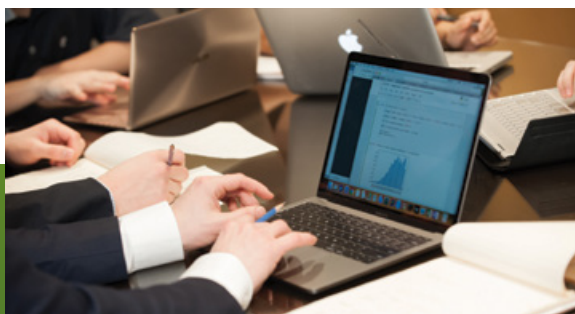

## ADMISSION REQUIREMENTS

70% minimum cumulative average in five Grade 12 academic subjects including English + math\* + two science subjects\*\*\*\* + one course from any academic area

*\*Pre-calculus and/or calculus is recommended.*

*\*\*For the Kinesiology program, the two science subjects must be chemistry and biology.*

*\*\*\*For the Applied Climate Change and Adaptation program, the two science subjects must be chosen from chemistry, biology, or physics*

*\*\*\*\*Some introductory courses at UPEI have high school prerequisites: Chemistry 1110 (a required course in many Science programs) requires Grade 12 academic chemistry or UPEI Chemistry 0001.*

Visit [upei.ca/admission-requirements](https://upei.ca/admission-requirements) for complete requirements for all UPEI programs.



# Faculty of Sustainable Design Engineering

UPEI's sustainable design engineering program is built on a foundation of real-world collaboration and industry partnerships, where our students apply their knowledge and skills to solve technical challenges for business and community clients. Our Faculty of Sustainable Design Engineering building is the perfect place for your post-secondary engineering education. Non-traditional learning spaces, design studios, ideation pods, product assembly labs, and a design competition centre are all specifically outfitted for your success. Focusing on sustainability, UPEI's Bachelor of Science in Sustainable Design Engineering program gives you a competitive edge in today's workforce after you graduate.



## ADMISSION REQUIREMENTS

65% minimum in each subject (70% in Grade 12 academic mathematics) with 70% minimum cumulative average in five Grade 12 academic subjects including English + math\*\* + two science subjects (chosen from biology, chemistry, or physics) + one course from any academic area

\*Some introductory courses at UPEI have high school prerequisites: Chemistry 1110 (a required course in the Engineering program) requires Grade 12 academic chemistry or UPEI Chemistry 0001; Math 1910 requires at least Grade 12 academic math. \*\*Pre-calculus and/or calculus is recommended.

Visit [upei.ca/admission-requirements](https://upei.ca/admission-requirements) for complete requirements for all UPEI programs.

## PROFESSIONAL PROGRAMS

# Faculty of Education

UPEI's unique one-year, post-degree Bachelor of Education offers specializations in adult education, Indigenous education, and international education to meet the current demands of all classroom environments. We also offer a French-language *baccalauréat en éducation—français langue seconde*. A four-year bachelor's degree in another discipline is required for admission.



### ADMISSION REQUIREMENTS

Applicants must have an undergraduate degree + an overall average of at least 70% on the 20 highest grades of the last 22 courses (3 semester hour of credit) + at least 6 semester hours of credit in English or equivalent + completed academic courses in subjects taught in the school system that satisfy the requirements for the program level (primary/elementary or intermediate/senior) into which they seek admission.

Visit [upei.ca/admission-requirements](https://upei.ca/admission-requirements) for complete requirements for all UPEI programs.



Nicole



**Bachelor of Education with  
Indigenous education focus**  
Fort St. James, British Columbia

“I chose UPEI’s Bachelor of Education program because the application process considered my previous experience in instructional settings, experience with children and youth, academic achievements, and other extended training. Identifying as Indigenous, I chose to specialize in the Indigenous education focus and complete my final practicum within an Indigenous community. Every staff and faculty member goes above and beyond to offer flexibility and adaptability, and having such a welcoming cohort of fellow students made moving to a new province and starting at a new university with a full course load feel achievable and fun!”

Read more about Nicole’s experiences as a UPEI Bachelor of Education student at [upei.ca/nicole](https://upei.ca/nicole)



# Faculty of Veterinary Medicine

The four-year Doctor of Veterinary Medicine program prepares students to work as veterinarians in private practice, academia, research, industry, and public service. A veterinary education on Prince Edward Island gives you direct access to unique study environments and many animal species. Learn about and work with farm animals, horses, aquatic species, domestic and exotic pets, wildlife, and others in our beautiful Island setting!

Our DVM program is fully accredited by the American and Canadian Veterinary Medical Associations and is recognized by the Royal College of Veterinary Surgeons in the United Kingdom. Graduates are eligible for licensure in Canada, the United States, the United Kingdom, Australia, and New Zealand. Residents of the four Atlantic provinces as well as international candidates can apply to the DVM program. Applicants must have at least 20 undergraduate credits to apply for this program.



## ADMISSION REQUIREMENTS

The DVM admissions process strives to select applicants most likely to succeed in the veterinary curriculum with the potential to become competent, responsible veterinarians dedicated to a lifetime of productive public service and continued learning.

Visit [upei.ca/admission-requirements](https://upei.ca/admission-requirements) for complete requirements for all UPEI programs.



## Anam

Doctor of Veterinary Medicine  
Halifax, Nova Scotia



“I’ve had many opportunities to attend conferences and symposiums to present my research and learn about advancements in veterinary medicine while studying at UPEI. I’ve also had the invaluable opportunity to work as a student assistant in the Large Animal Hospital at the Atlantic Veterinary College, which has enabled me to learn and hone new skills and study large animal medicine in a very hands-on environment.”

Read more about Anam’s experiences as a DVM student at [upei.ca/anam](https://upei.ca/anam)





# Faculty of Medicine

In partnership with Memorial University, UPEI's Doctor of Medicine program brings together the strengths of both institutions in rural and family medicine, nursing, clinical psychology, and paramedicine. By leveraging UPEI's existing programs in veterinary medicine, kinesiology, dietetics, climate change and adaptation, and sustainable design engineering, the UPEI Faculty of Medicine increases training opportunities for future family doctors and general specialists. The first intake of 20 students is expected to be in 2025.



## ADMISSION REQUIREMENTS

\*A bachelor's degree in any discipline from an accredited post-secondary institution, successful completion of the Medical College Admission Test (MCAT), and the CASPer exam.

*Note: Admission to the MD program is very competitive. All applicants must meet Prince Edward Island residency requirements.*

\*Memorial University program requirements

Visit [upei.ca/admission-requirements](https://upei.ca/admission-requirements) for complete requirements for all UPEI programs.

## ARTICULATION AND TRANSFER PATHWAYS



[upei.ca/transfer](https://upei.ca/transfer)

UPEI has several transfer and articulation agreements to provide degree pathways to graduates of specific college programs: Bachelor of Applied Health in Paramedicine (*formerly the Bachelor of Science in Paramedicine*), Bachelor of Applied Science in Radiography, Bachelor of Wildlife Conservation, Bachelor of Science in Biotechnology, Accelerated Bachelor of Business Administration, and others!

## GRADUATE PROGRAMS



[upei.ca/gradstudies](https://upei.ca/gradstudies)

# Faculty of Graduate Studies

Take your academic study and career further with UPEI's growing number of graduate programs! We offer thesis- and course-based options, faculty-supervised and cohort programs, and a wide range of graduate degree specializations. The graduate student experience at UPEI is extraordinary! Contribute to exciting and valuable research and development projects, learn from internationally recognized experts in your chosen field, and connect with the academic and business community. Intake dates and admission requirements vary by program.

Visit [upei.ca/admission-requirements](https://upei.ca/admission-requirements) for complete requirements for all UPEI programs.

# A perfect place to learn



## Nathalie

**Master of Business Administration in Global Leadership**  
Central Village, St. Catherine, Jamaica



“For such a small island on the east coast of Canada, I feel like I have seen so much of the world without ever leaving PEI. My closest friends are from China, The Bahamas, Vietnam, Mauritius, Nigeria, and Canada. My team at work consists of persons from Mali, India, and Brazil. My current MBA cohort has students from at least 10 different countries.”

“I can have Thai, Indian, or Jamaican food, depending on what I feel like on a given day, and when I walk across campus, so many different languages can be heard as friends stand and chat. How beautiful is that? Talk about a perfect place to learn about diversity and form networks for business in different countries!”

A graduate of UPEI's Bachelor of Business Administration program (Class of 2018), Nathalie is now enjoying her experience in the Master of Business Administration in Global Leadership program. Read more at [upei.ca/nathalie](https://upei.ca/nathalie)



# Faculty and Program Index

PROGRAMS	DEGREES, CERTIFICATES, DIPLOMAS	HONOURS
Acadian Studies <sup>^</sup>	Bachelor of Arts (BA), Bachelor of Business Administration (BBA), Bachelor of Science (BSc)	
Accounting*	Certificate	
Actuarial Science	BSc <i>specialization: pre-professional</i>	
Adult Education*	Certificate	
Applied Climate Change and Adaptation	Bachelor of Applied Science in Climate Change and Adaptation	
Applied Communication, Leadership, and Culture	BA	
Asian Studies <sup>^</sup>	BA, BBA, BSc	
Analytics	BSc <i>specializations:</i> business analytics data analytics	
Anthropology	BA	Y
Biology	BSc <i>specializations:</i> life sciences pre-veterinary environmental biology	Y
Biomedical Physics <sup>^</sup>	BA, BBA, BSc	
Biotechnology	Bachelor of Science in Biotechnology	
Biotechnology <sup>^</sup>	BA, BBA, BSc	
Business Administration	BBA <i>specializations:</i> accounting entrepreneurship finance international business marketing organizational management tourism and hospitality	Y
Business Administration*	Certificate	
Business Studies	Bachelor of Business Studies	
Catholic Studies <sup>^</sup>	BA, BBA, BSc	
Chemistry	BSc	Y

<sup>^</sup>minor program; declared with major after second year

\*program open to Canadian students only

REQUIREMENTS	ACCELERATED PROGRAM, COLLEGE PATHWAY, OR CO-OPERATIVE EDUCATION OPTIONS
<i>for non-Business students</i>	
70% minimum cumulative average in five Grade 12 academic subjects including English + math + two science subjects + one other course	Co-op
70% minimum cumulative average in five Grade 12 academic subjects including English + math + two science subjects + one other course	
70% minimum cumulative average in five Grade 12 academic subjects	Co-op
70% minimum cumulative average in five Grade 12 academic subjects including English + math + two science subjects + one other course	Co-op
70% minimum cumulative average in five Grade 12 academic subjects	
70% minimum cumulative average in five Grade 12 academic subjects including English + math + two science subjects + one other course	Co-op
	College Pathway (2+1+1)
70% minimum cumulative average in five Grade 12 academic subjects	Accelerated Program College Pathway Co-op
<i>for non-Business students</i>	
	College Pathway
70% minimum cumulative average in five Grade 12 academic subjects including English + math + two science subjects + one other course	Co-op

PROGRAMS	DEGREES, CERTIFICATES, DIPLOMAS	HONOURS
Christian Studies <sup>^</sup>	BA, BBA, BSc	
Computer Science	BSc <i>specialization: video game programming</i>	Y
Canadian Studies <sup>^</sup>	BA, BBA, BSc	
Diversity and Social Justice Studies	BA	
Economics	BA	
Education	Bachelor of Education (BEd) <i>specializations:</i> adult education Indigenous education international education	
Education	BEd - français langue seconde	
English	BA	Y
Engineering	Bachelor of Science in Sustainable Design Engineering	
Environmental Studies	Bachelor of Environmental Studies <i>specializations:</i> environmental innovation and change management environmental thought and practice island environments and sustainability	
Financial Mathematics	BSc	
Foods and Nutrition	BSc	Y
French	BA	
History	BA	Y
Indigenous Studies <sup>^</sup>	BA, BBA, BSc	
Integrated Studies*	Bachelor of Integrated Studies	
International Studies <sup>^</sup>	BA, BBA, BSc	
Island Studies <sup>^</sup>	BA, BBA, BSc	
Journalism	Bachelor of Applied Arts in Journalism	
Kinesiology	BSc	Y
Korean Studies <sup>^</sup>	BA, BBA, BSc	
Mathematics	BSc	Y
Medieval and Renaissance Studies <sup>^</sup>	BA	
Music <sup>^</sup>	BA, BBA, BSc	
Music	Bachelor of Music	

<sup>^</sup>minor program; declared with major after second year

\*program open to Canadian students only



REQUIREMENTS	ACCELERATED PROGRAM, COLLEGE PATHWAY, OR CO-OPERATIVE EDUCATION OPTIONS
70% minimum cumulative average in five Grade 12 academic subjects including English + math + two science subjects + one other course	Co-op
70% minimum cumulative average in five Grade 12 academic subjects	
70% minimum cumulative average in five Grade 12 academic subjects post-degree program	Co-op
post-degree program	
70% minimum cumulative average in five Grade 12 academic subjects	
65% minimum in each subject (70% in Grade 12 academic mathematics) with 70% minimum cumulative average in five Grade 12 academic subjects including English + math + two science subjects + one course	
70% (75% for Quebec Secondary V students) in English, one social studies or language, and any 3 other academic courses. Grade 12 math recommended	College Pathway Co-op
70% minimum cumulative average in five Grade 12 academic subjects including English + math + two science subjects + one other course	Co-op
70% minimum cumulative average in five Grade 12 academic subjects including English + math + two science subjects + one other course	Co-op
70% minimum cumulative average in five Grade 12 academic subjects	
70% minimum cumulative average in five Grade 12 academic subjects	
	College Pathway
70% minimum cumulative average in five Grade 12 academic subjects including English + math + two science subjects + one other course	College Pathway
70% minimum cumulative average in five Grade 12 academic subjects including English + math + two science subjects + one other course	Co-op
70% minimum cumulative average in English; one social studies or language; and any 3 other academic courses (Grade 12 math recommended)	

PROGRAMS	DEGREES, CERTIFICATES, DIPLOMAS	HONOURS
Music Education	Bachelor of Music Education	
Nursing	Bachelor of Science in Nursing (BScN)	
Paramedicine	Bachelor of Applied Health in Paramedicine	Y
Philosophy	BA	Y
Physics	BSc <i>specialization: medical and biological physics</i>	Y
Political Science	BA	
Psychology	BA	Y
Psychology	BSc	Y
Public Administration*	Certificate	
Public Administration*	Diploma	
Radiography	Bachelor of Applied Science in Radiography	
Religious Studies	BA	
Sociology/Anthropology	BA	Y
Social Studies of Science^	BA, BBA, BSc	
Sociology	BA	Y
Spanish	BA	
Statistics	BSc	Y
Theatre Studies^	BA, BBA, BSc	
Tourism and Hospitality	Bachelor of Business in Tourism and Hospitality	
University Writing^	BA, BBA, BSc	
Veterinary Medicine	Doctor of Veterinary Medicine (DVM)	
Wildlife Conservation	Bachelor of Wildlife Conservation	

<sup>^</sup>minor program; declared with major after second year

\*program open to Canadian students only

## GRADUATE STUDIES

Doctor of Philosophy in Educational Studies	PhD
Doctor of Philosophy in Environmental Sciences	PhD
Doctor of Philosophy in Molecular and Macromolecular Sciences	PhD
Doctor of Philosophy in Sustainable Design Engineering	PhD

Doctor of Philosophy in Veterinary Medicine	PhD
Doctor of Psychology	PsyD
Master of Arts in Island Studies	MA
Master of Applied Health Services Research	MAHSR
Master of Business Administration	MBA
Master of Business Administration in Global Leadership	MBA-GL

REQUIREMENTS	ACCELERATED PROGRAM, COLLEGE PATHWAY, OR CO-OPERATIVE EDUCATION OPTIONS
65% minimum in each subject with 70% cumulative average in five Grade 12 academic subjects including English + math + chemistry + biology + one course	Accelerated Program College Pathway
70% minimum cumulative average in five Grade 12 academic subjects	College Pathway
70% minimum cumulative average in five Grade 12 academic subjects including English + math + two science subjects + one other course	Co-op
70% minimum cumulative average in five Grade 12 academic subjects	
70% minimum cumulative average in five Grade 12 academic subjects	
70% minimum cumulative average in five Grade 12 academic subjects including English + math + two science subjects + one other course	
for non-Business students	
ten (10) first-year UPEI science courses	
70% minimum cumulative average in five Grade 12 academic subjects	
70% minimum cumulative average in five Grade 12 academic subjects	
70% minimum cumulative average in five Grade 12 academic subjects	
70% minimum cumulative average in five Grade 12 academic subjects	
70% minimum cumulative average in five Grade 12 academic subjects including English + math + two science subjects + one other course	Co-op
	College Pathway
<i>post-degree program (or two-year foundational program)</i>	College Pathway

<b>Master of Education in Leadership and Learning</b>	MEd
<b>Master of Nursing</b>	MN
<b>Master of Science</b>	MSc
<b>Master of Veterinary Science</b>	MVSc



# A look into your future

Your hard work pays off on **Convocation Day** when you celebrate your success as a **UPEI student!** It is the culmination of everything you've worked to achieve.

But your UPEI journey isn't over when you graduate! You'll join a worldwide network of almost **30,000** UPEI alumni in more than **80** countries.

**APPLY TO UPEI AND TURN YOUR FUTURE INTO REALITY.**  
**LET US HELP YOU FIND YOUR GENIUS AT UPEI.**



# APPLY TO UPEI TODAY!

Follow our five-step application process and start your UPEI journey!

*We can't wait  
to welcome you  
to the University  
of Prince Edward  
Island!*

Steps  
1

## CREATE A UPEI ACCOUNT



Visit [upei.ca/apply](https://upei.ca/apply) to create a UPEI account.

You can use your account to start an application, book a UPEI campus tour, sign up for enrolment team visits to your school, and contact our enrolment services team.

## 2 COMPLETE YOUR ONLINE APPLICATION

Complete an online application form.

Some of our programs require a slightly different application process, but don't worry! You can always contact our enrolment team for help.

## 3 SUBMIT YOUR UPEI APPLICATION FEE AND COMPLETED APPLICATION

You will receive an email message from our enrolment team to confirm receipt of your application and application fee.

## 4 SUBMIT YOUR TRANSCRIPTS AND SUPPORTING DOCUMENTATION

Send your transcripts by:

Email: [registrar@upei.ca](mailto:registrar@upei.ca)

Fax: (902) 566-0795

Mail: UPEI Registrar's Office

550 University Avenue

Charlottetown, PE C1A 4P3

Canada

Transcripts sent directly from your school are considered "official," and all other transcripts are considered "unofficial."

Some programs require supplemental documents, so check your UPEI account for details.

## 5 CHECK YOUR APPLICATION STATUS BY LOGGING INTO YOUR ACCOUNT

If you have any questions or concerns about your application status, let us know! Send us a message at [apply@upei.ca](mailto:apply@upei.ca) or call us at 1-800-606-8734.

# From application to first day of class

## APPLICATION TIMELINE

Stay connected with UPEI with our month-to-month timeline! Step one our enrolment team whenever you have a question.

### SEPTEMBER 2023

- Start your **UPEI application!** Visit [upei.ca/apply](https://upei.ca/apply) and create an application account.
- Submit your unofficial current transcripts for an early review of your application.
- Do your high school courses meet UPEI's admission requirements for your program of interest? Email [apply@upei.ca](mailto:apply@upei.ca) for help.

### OCTOBER 2023

- Attend **UPEI's Fall Open House!** Take advantage of on-site admission, waived application fees, campus tours, and faculty-specific events.
- Can't decide which program is for you? Visit [upei.ca/programs](https://upei.ca/programs). There's something for everyone!
- **Search for scholarships!** Visit [upei.ca/scholarships](https://upei.ca/scholarships) to review awards by year of study and program.

### NOVEMBER 2023

- Apply to live in one of **UPEI's residences.** Visit [upei.ca/residence](https://upei.ca/residence) to start your residence application.
- Did you miss our **Fall Open House?** Book a personalized campus tour! Email [apply@upei.ca](mailto:apply@upei.ca).

### DECEMBER 2023

- See what UPEI is all about on our Instagram, Facebook, Snapchat, YouTube, and TikTok accounts.
- We would love to talk to you about **UPEI!** Set up a video chat with our advisement team, or email us at [apply@upei.ca](mailto:apply@upei.ca) with any questions.

### APRIL 2024

- International students should apply for their Canadian study permit.
- Activate the UPEI email address you received in your acceptance package.
- We will notify you about waitlists, **New Student Orientation**, and other **UPEI activities**.
- Finalize your living arrangements if possible.
  - Applications for residence are still open!
  - If you're planning to live off-campus, start searching at [upei.ca/offcampushousing](https://upei.ca/offcampushousing).

### MAY 2024

- **It's not too late to apply!** We'd love to send you an acceptance letter.
- Students should confirm their room in residence and pay the residence room deposit.

### JUNE 2024

- High school students: Ask your school to send a final official transcript to the **UPEI Registrar's Office**.
- Prepare your finances. For Canadian students, student loans vary by province.
- Join the **New Student Orientation** page on **Facebook**, and follow **UPEI NSO** on Instagram to connect with other incoming students!

## is starting your application as soon as possible and contacting

### JANUARY 2024

- This is a great time to check in with your high school guidance counsellor! Talk to them about **UPEI's** requirements, financing, and eligible scholarships.
- If you are a high school student, you should submit official transcripts to the **UPEI Registrar's Office** at the end of your school's first term.

### FEBRUARY 2024

- Log into your application account to verify that we have received your required documents, and your application is complete and ready for review.
- If you haven't applied yet, register for **UPEI's Winter Open House!**
- Applications for the Bachelor of Science in Nursing program are due on **February 15**.

### MARCH 2024

- Refresh your email inbox! **UPEI acceptance letters are on their way via email.** Don't forget to celebrate your good news with a social post (**#PantherProud!**)
- Course registration is open. Pay your tuition deposit, and register for your first- and second-semester courses.
- UPEI's Entrance Award Cycle scholarship application is due on March 1! Scholarship applications can be submitted by email to [scholarships@upei.ca](mailto:scholarships@upei.ca).

### JULY 2024

- You will receive a final reminder to register for your first-year courses.
- If you are going to live in residence, you'll be notified about your roommate.

### AUGUST 2024

- Check your **UPEI** email for **New Student Orientation** registration and scheduling details!
- Residence students will find out about room assignments, so start preparing the essentials for move-in day at the end of the month (check out the helpful list at [upei.ca/residence](http://upei.ca/residence)).

### SEPTEMBER 2024

- ☑ **Time for New Student Orientation, and your first day of classes!** ✨

# Campus map

CONFEDERATION TRAIL



**UNIVERSITY**  
of Prince Edward  
**ISLAND**



## UPEI CAMPUS BUILDINGS

- |                                     |                                                 |                                                               |
|-------------------------------------|-------------------------------------------------|---------------------------------------------------------------|
| 1 CHI-WAN YOUNG SPORTS CENTRE (YSC) | 12 DON AND MARION MCDUGALL HALL (MCDH)          | 21 PERFORMING ARTS CENTRE AND RESIDENCE (PAC)                 |
| 2 CENTRAL UTILITY BUILDING (CUB)    | 13 DUFFY SCIENCE CENTRE (DSC)                   | 24 BLANCHARD HALL (BLH) (RESIDENCE)                           |
| 3 HEALTH SCIENCES BUILDING (HSB)    | 14 CHAPLAINCY CENTRE (CC)                       | 27 ATLANTIC VETERINARY COLLEGE (AVC)                          |
| 4 W.A. MURPHY STUDENT CENTRE (MSC)  | 15 ROBERTSON LIBRARY (RL)                       | 28 REGIS AND JOAN DUFFY RESEARCH CENTRE (DRC)                 |
| 5 SDU MAIN BUILDING (SDMB)          | 16 DAYCARE BUILDING (DCB)                       | 30 FACULTY OF SUSTAINABLE DESIGN ENGINEERING BUILDING (FSDEB) |
| 6 STEEL BUILDING (SB)               | 17 K.C. IRVING CHEMISTRY CENTRE (ICC)           | 33 ARTIFICIAL TURF FIELD ANNOUNCERS' BUILDING                 |
| 7 DALTON HALL (DH)                  | 18 WANDA WYATT DINING HALL (WDH)                |                                                               |
| 9 MEMORIAL HALL (MH)                | 19 BILL AND DENISE ANDREW HALL (AH) (RESIDENCE) |                                                               |
| 10 CASS SCIENCE HALL (CSH)          | 20 BERNARDINE HALL (BEH) (RESIDENCE)            |                                                               |







### PARKING

- 34 CLUBHOUSE
- 35 ALUMNI CANADA GAMES PLACE STORAGE BUILDING
- 36 ALUMNI CANADA GAMES PLACE ANNOUNCERS' BUILDING
- 37 ALUMNI CANADA GAMES PLACE VIP BUILDING
- 38 ALUMNI HALL (ALH)
- 39 MEDICAL BUILDING (UNDER CONSTRUCTION)

- PA GENERAL (OVERNIGHT DURING WINTER MONTHS)
- PB GENERAL AND DESIGNATED
- PC DESIGNATED
- PD GENERAL
- PE GENERAL
- PF DESIGNATED
- PG DESIGNATED
- ACCESSIBLE
- AQUATICS FACILITY PARKING
- DRC DUFFY RESEARCH CENTRE
- MACLAUCHLAN ARENA PARKING

- RO RESIDENCE ONLY
- RP RESERVED
- SR SHIPPING AND RECEIVING
- VP VISITOR METERED
- VTH VETERINARY TEACHING HOSPITAL CLIENTS

-  BUS STOP
-  CAMPUS ENTRANCE
-  EMERGENCY CALL STATION



Notes



A series of horizontal green lines providing a template for writing notes.

# Questions?

## WE HAVE THE ANSWERS!

Contact us today by email and by telephone—and don't forget to follow, subscribe, like, and watch!

### APPLICATIONS AND ADMISSIONS

[apply@upei.ca](mailto:apply@upei.ca)  
902-566-0439

### INTERNATIONAL STUDENT OFFICE

[inte@upei.ca](mailto:inte@upei.ca)  
902-566-0576

### BOOK A PERSONALIZED CAMPUS TOUR

[upei.ca/tour](http://upei.ca/tour)  
800-606-8734

### GENERAL INQUIRIES

[apply@upei.ca](mailto:apply@upei.ca)  
800-606-8734  
902-628-4353

### SOCIAL MEDIA

 /UniversityofPEI

 /upei

 /UofPEI

 @universityofpei

 /add/uofpei



UNIVERSITY  
of Prince Edward  
ISLAND

550 University Avenue  
Charlottetown, PE  
Canada C1A 4P3

[upei.ca](http://upei.ca)