

Edit or Delete a Preset

Edit a Preset

1. Open the **Preset Menu** (*thumbtack*) on the **Menu Bar**, and click on **“Customize this menu”** link. The link will appear by hovering inside the menu content area.

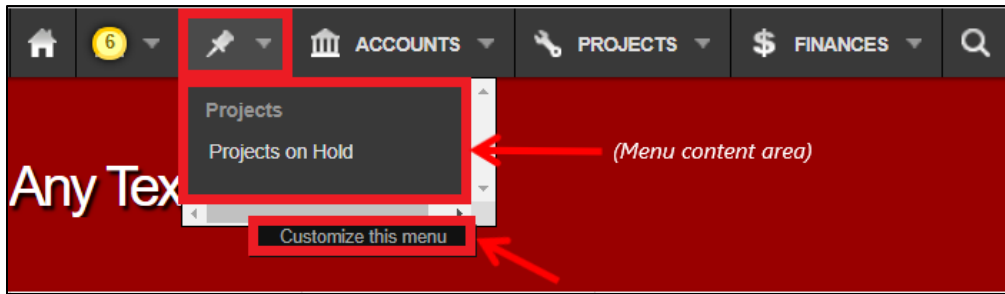

2. At the **Custom Menu** page, click on the link of the **Preset** to be edited.

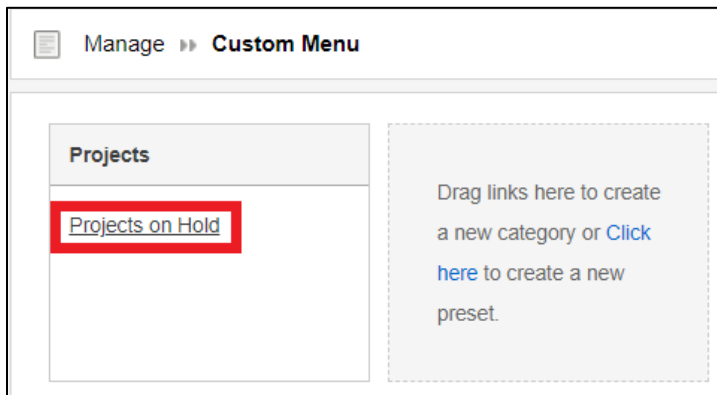

3. Make changes to the filter options, and then click the **“Save Preset”** button. (*The Preset Name was also edited in the example below.*)

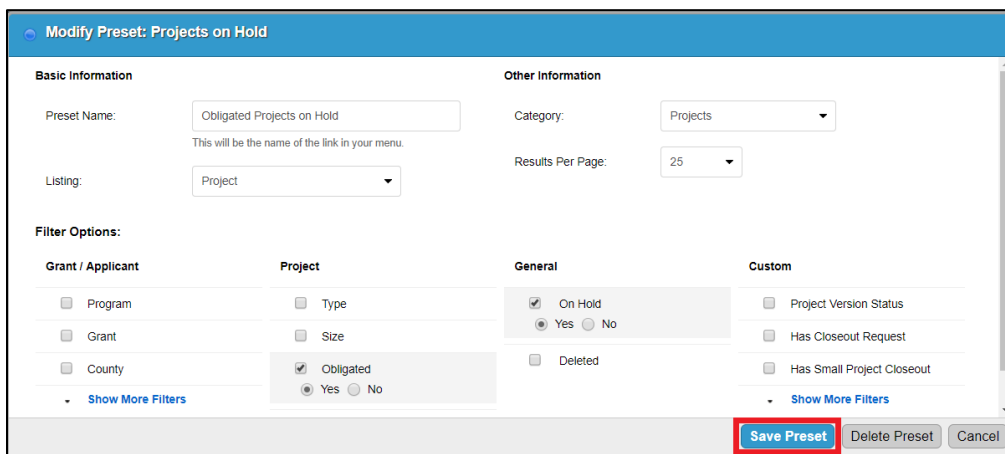

4. A green check mark **Preset Saved** will appear briefly. The edits have now been saved.

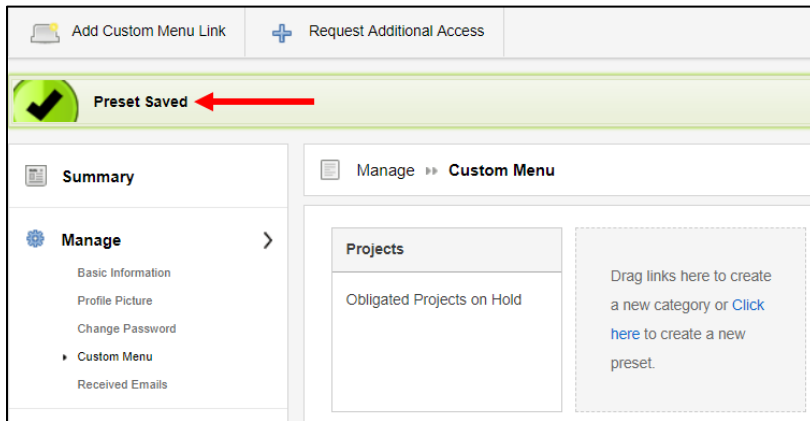

Delete a Preset

1. Open the **Preset Menu** (*thumbtack*) on the **Menu Bar**, and click on **“Customize this menu”** link. The link will appear by hovering inside the menu content area.

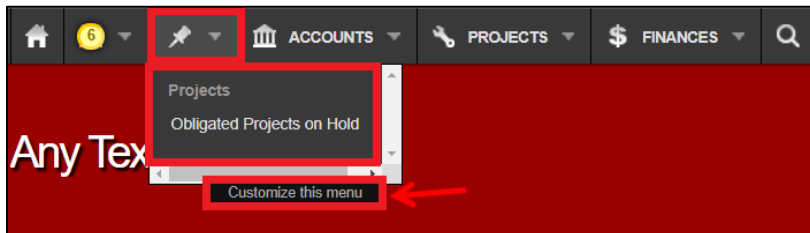

2. At the **Custom Menu** page, click the link of the **Preset** to be deleted.

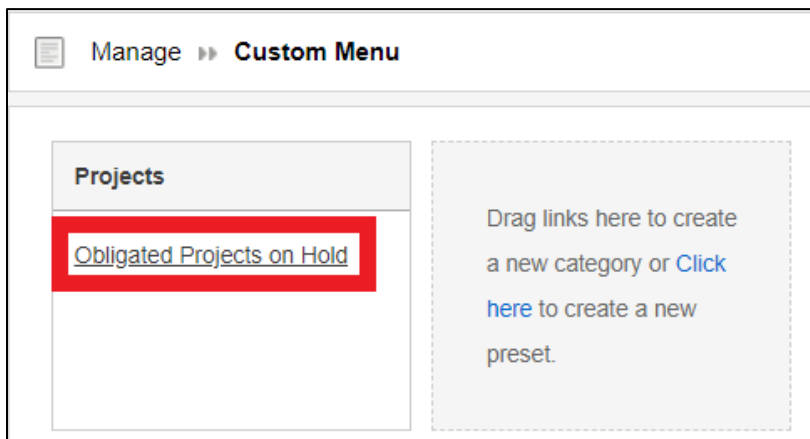

3. Click the **“Delete Preset”** button. A window will display asking **“Are you sure?”** (*Are you sure you want to delete this preset?*) Click the **“Yes”** button to delete.

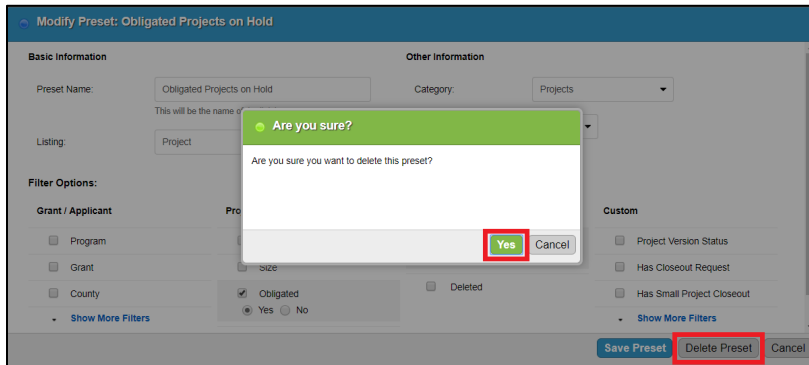

4. A green check mark **Preset Deleted** will appear briefly.

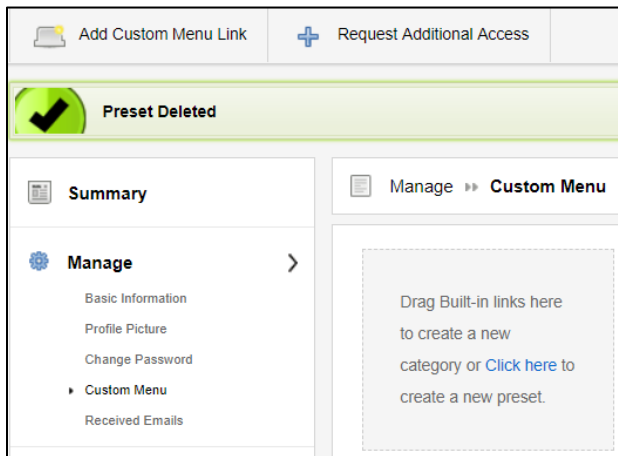

5. The preset has been removed from the **Preset Menu** (*thumbtack*), and the **Custom Menu**.

